

  **DEMOLITION PLAN - UNIT 400**
SCALE: 1/8" = 1'-0"

ARCHITECTURAL GENERAL DEMOLITION NOTES

1. THE DEMOLITION PLANS GENERALLY INDICATE AREAS OF EXTENSIVE REMOVALS AND DO NOT INDICATE ALL OF THE WORK. CONTRACTOR SHALL PERFORM ALL THE DEMOLITION WHICH IS NECESSARY FOR THE PROPER EXECUTION OF THE PROJECT, WHETHER OR NOT SAID DEMOLITION IS SPECIFICALLY INDICATED WITHIN THE DOCUMENTS.
2. CONTRACTOR IS RESPONSIBLE TO COORDINATE WITH ALL OTHER DRAWINGS AND SPECIFICATIONS FOR OTHER AREAS THAT WILL REQUIRE DEMOLITION NOT INDICATED ON THESE SHEETS.
3. CONTRACTOR IS RESPONSIBLE TO INFILL, PATCH AND/OR REPAIR EXISTING WALLS, FLOORS AND CEILINGS TO MATCH EXISTING WHERE DEMOLITION OCCURS OTHER THAN AS DESCRIBED IN THESE DOCUMENTS.
4. IT IS THE INTENTION OF THESE DOCUMENTS THAT THE DEMOLITION OF PORTIONS OF MASONRY WALLS (BOTH INTERIOR AND EXTERIOR) ARE GENERALLY TO BE DONE ALONG JOINT AND COURSING LINES.
5. PATCH AND REPAIR REMAINING ADJACENT SURFACES AT AREAS OF REMOVAL AND/OR ALTERATION TO MATCH EXISTING. PROVIDE A SOUND AND PROPER SUBSTRATE FOR NEW FINISH. COORDINATE WITH COLOR PLANS. WHERE A NEW FINISH IS NOT INDICATED, MATCH EXISTING ADJACENT FINISHES.
6. ALL DEMOLITION IS TO BE DONE WITH REASONABLE CARE AS TO MINIMIZE DAMAGE TO EXISTING REMAINING SURFACES. CONTRACTOR IS RESPONSIBLE TO PROPERLY DISPOSE OF ALL DEMOLISHED ITEMS NOT INDICATED TO BE RELOCATED OR TURNED OVER TO OWNER.
7. PRIOR TO DEMOLITION, CONTRACTOR SHALL COORDINATE ALL ITEMS TO BE SALVAGED FOR REUSE ON THE PROJECT AND/OR RETURNED TO THE OWNER THRU THE CONSTRUCTION MANAGER. A FINAL LIST OF ITEMS SHALL BE COMPLETED BEFORE CONSTRUCTION BEGINS. ALL SUCH ITEMS SHALL BE REMOVED AND PROPERLY PACKED AND STORED TO MAINTAIN AS FOUND CONDITION.
8. COORDINATE DEMOLITION WORK FOR DOOR AND FRAMES WITH DOOR SCHEDULE.
9. CLEAN AND PREPARE ALL EXISTING SURFACES WHICH ARE TO BE PAINTED/ PATCHED. PREPARATION TO INCLUDE MINOR PATCHING. COORDINATE WITH COLOR PLANS FOR LOCATIONS.
10. PROVIDE TEMPORARY SHORING, BRACING, AND/OR SUPPORTS AS REQUIRED FOR WALL AND/OR ROOF AT AREAS OF REMOVAL AND ALTERATION.
11. COORDINATE WITH MECHANICAL AND ELECTRICAL DRAWINGS FOR FURTHER DEMOLITION NOTES.
12. PAINT TO MATCH ADJACENT SURFACES AT AREAS DISTURBED BY MECHANICAL OR ELECTRICAL DEMOLITION, U.N.O.
13. COORDINATE WITH TECHNOLOGY DRAWINGS FOR FURTHER DEMOLITION NOTES.

ARCHITECTURAL DEMOLITION NOTES

- 1 FLOORS
A REMOVE AND PROPERLY DISPOSE OF VGT AND RUBBER BASE. PREP SUB-FLOOR TO BE SUITABLE FOR NEW FLOOR FINISH INSTALLATION.
- 2 WALLS
A REMOVE AND CLEAN MASONRY GROUT JOINTS WHERE MASONRY SETTLED AND JOINTS WERE COMPROMISED.
- 3 CEILINGS
A X
- 4 DOORS & WINDOWS
A REMOVE AND DISPOSE OF EXTERIOR DOOR, INCLUDING FRAME, SIDELIGHTS, LOUVERS AND ALL RELATED ANCHORS, SUPPORTS AND HARDWARE. SANCUT FRAME ANCHORS. TRYING ANCHORS FROM SUBSTRATES IS UNACCEPTABLE. PREP OPENING FOR NEW DOOR FRAME AND DOOR INSTALLATION.
- 5 TOILETS
A REMOVE AND SALVAGE TOILET FOR REINSTALLATION- REFER TO PLUMBING DEMO PLANS. PREP REMAINING SURFACES TO RECEIVE NEW CONSTRUCTION AND/OR FINISHES. TOILETS TO BE REINSTALLED AFTER NEW FLOORING INSTALL.
- 7 CASEWORK
A REMOVE AND PROPERLY DISPOSE OF COUNTERTOP & BACKSPLASH, INCLUDING ALL ANCHORS, ATTACHMENTS, ETC. PREP EXISTING FINISHES TO RECEIVE NEW TOP. REMOVE AND SALVAGE EXISTING SINK AND FAUCET FOR REINSTALLATION.

Kingscott

KALAMAZOO | GRAND RAPIDS | CHELSEA
259 East Michigan Ave., Suite 308
Kalamazoo, MI 49007-6403
P: 269.381.4880 | F: 269.381.9110
www.kingscott.com



Strategic Energy Solutions
4000 West Eleven Mile Road, Berley, MI 48072
Phone 248.399.1900 Fax 248.399.1901
www.sesnet.com

**Barton
Malow**

Saline Area Schools
2017 Projects
Woodland Meadow Elementary
Saline, Michigan

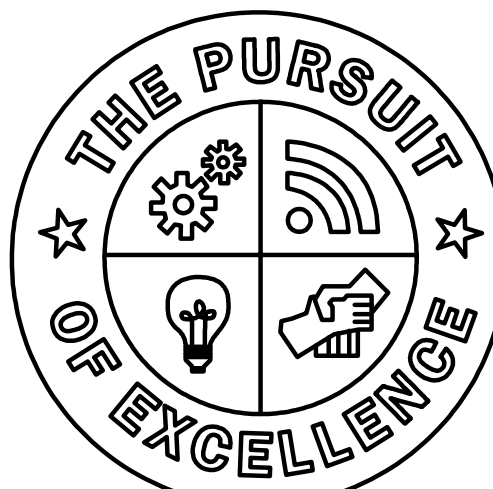

Saline
Area Schools

REVISIONS/REVIEW DATE
ISSUED FOR BID 01-06-2017

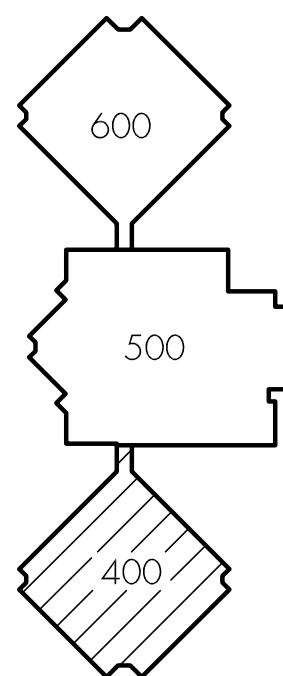

JOB NO. 2900-03



SHEET TITLE

DEMOLITION PLAN - UNIT 400

SHEET NO.

WM-D1.1

WM-D1.1

© KINGSKOTT ASSOCIATES INC. KALAMAZOO, MICHIGAN

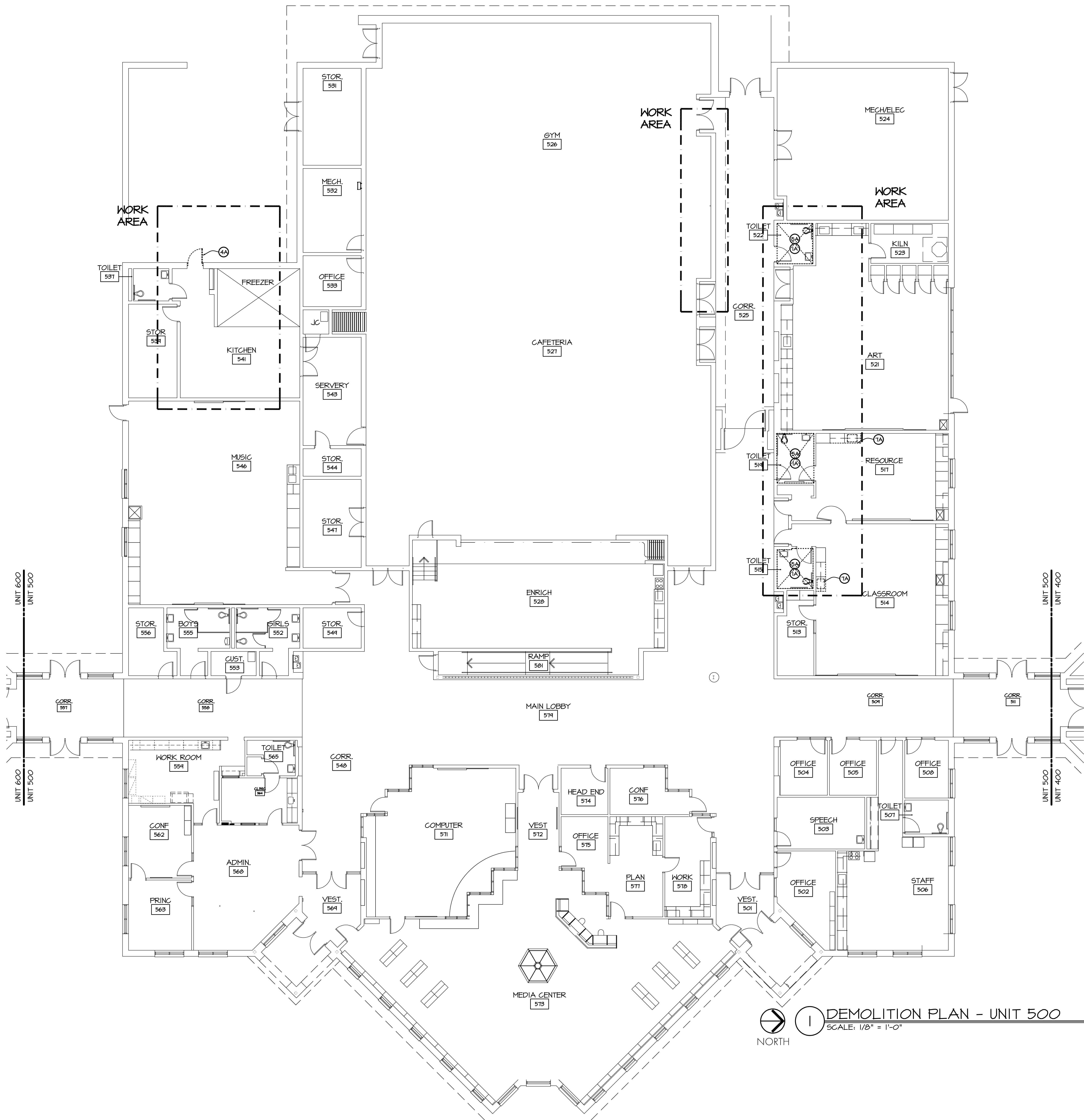

ARCHITECTURAL GENERAL DEMOLITION NOTES

- THE DEMOLITION PLANS GENERALLY INDICATE AREAS OF EXTENSIVE REMOVALS AND DO NOT INDICATE ALL OF THE WORK. CONTRACTOR SHALL PERFORM ALL THE DEMOLITION WHICH IS NECESSARY FOR THE PROPER EXECUTION OF THE PROJECT, WHETHER OR NOT SAID DEMOLITION IS SPECIFICALLY INDICATED WITHIN THE DOCUMENTS.
- CONTRACTOR IS RESPONSIBLE TO COORDINATE WITH ALL OTHER DRAWINGS AND SPECIFICATIONS FOR OTHER AREAS THAT WILL REQUIRE DEMOLITION NOT INDICATED ON THESE SHEETS.
- CONTRACTOR IS RESPONSIBLE TO INFILL, PATCH AND/OR REPAIR EXISTING WALLS, FLOORS AND CEILINGS TO MATCH EXISTING WHERE DEMOLITION OCCURS OTHER THAN AS DESCRIBED IN THESE DOCUMENTS.
- IT IS THE INTENTION OF THESE DOCUMENTS THAT THE DEMOLITION OF PORTIONS OF MASONRY WALLS (BOTH INTERIOR AND EXTERIOR) ARE GENERALLY TO BE DONE ALONG JOINT AND COURSE LINES.
- PATCH AND REPAIR REMAINING ADJACENT SURFACES AT AREAS OF REMOVAL AND/OR ALTERATION TO MATCH EXISTING. PROVIDE A SOUND AND PROPER SUBSTRATE FOR NEW FINISH. COORDINATE WITH COLOR PLANS. WHERE A NEW FINISH IS NOT INDICATED, MATCH EXISTING ADJACENT FINISHES.
- ALL DEMOLITION IS TO BE DONE WITH REASONABLE CARE AS TO MINIMIZE DAMAGE TO EXISTING REMAINING SURFACES. CONTRACTOR IS RESPONSIBLE TO PROPERLY DISPOSE OF ALL DEMOLISHED ITEMS NOT INDICATED TO BE RELOCATED OR TURNED OVER TO OWNER.
- PRIOR TO DEMOLITION, CONTRACTOR SHALL COORDINATE ALL ITEMS TO BE SALVAGED FOR REUSE ON THE PROJECT AND/OR RETURNED TO THE OWNER THRU THE CONSTRUCTION MANAGER. A FINAL LIST OF ITEMS SHALL BE COMPLETED BEFORE CONSTRUCTION BEGINS. ALL SUCH ITEMS SHALL BE REMOVED AND PROPERLY PACKED AND STORED TO MAINTAIN AS FOUND CONDITION.
- COORDINATE DEMOLITION WORK FOR DOOR AND FRAMES WITH DOOR SCHEDULE.
- CLEAN AND PREPARE ALL EXISTING SURFACES WHICH ARE TO BE PAINTED/ PATCHED. PREPARATION TO INCLUDE MINOR PATCHING. COORDINATE WITH COLOR PLANS FOR LOCATIONS.
- PROVIDE TEMPORARY SHORING, BRACING, AND/OR SUPPORTS AS REQUIRED FOR WALL AND/OR ROOF AT AREAS OF REMOVAL AND ALTERATION.
- COORDINATE WITH MECHANICAL AND ELECTRICAL DRAWINGS FOR FURTHER DEMOLITION NOTES.
- PAINT TO MATCH ADJACENT SURFACES AT AREAS DISTURBED BY MECHANICAL OR ELECTRICAL DEMOLITION, U.N.O.
- COORDINATE WITH TECHNOLOGY DRAWINGS FOR FURTHER DEMOLITION NOTES.

ARCHITECTURAL DEMOLITION NOTES

- FLOORS
 - A REMOVE AND PROPERLY DISPOSE OF VCT AND RUBBER BASE. PREP SUB-FLOOR TO BE SUITABLE FOR NEW FLOOR FINISH INSTALLATION.
- HALLS
 - A REMOVE AND CLEAN MASONRY GROUT JOINTS WHERE MASONRY SETTLED AND JOINTS WERE COMPROMISED.
- CEILINGS
 - A X
- DOORS & WINDOWS
 - A REMOVE AND DISPOSE OF EXTERIOR DOOR, INCLUDING FRAME, SIDELIGHTS, LOUVERS AND ALL RELATED ANCHORS, SUPPORTS AND HARDWARE. SAWCUT FRAME ANCHORS, PRYING ANCHORS FROM SUBSTRATES IS UNACCEPTABLE. PREP OPENING FOR NEW DOOR FRAME AND DOOR INSTALLATION.
- TOILETS
 - A REMOVE AND SALVAGE TOILET FOR REINSTALLATION- REFER TO PLUMBING DEMO PLANS. PREP REMAINING SURFACES TO RECEIVE NEW CONSTRUCTION AND/OR FINISHES. TOILETS TO BE REINSTALLED AFTER NEW FLOORING INSTALL.
- CASEWORK
 - A REMOVE AND PROPERLY DISPOSE OF COUNTERTOP & BACKSPLASH, INCLUDING ALL ANCHORS, ATTACHMENTS, ETC. PREP EXISTING FINISHES TO RECEIVE NEW TOP. REMOVE AND SALVAGE EXISTING SINK AND FAUCET FOR REINSTALLATION.

Kingscott

KALAMAZOO | GRAND RAPIDS | CHELSEA
259 East Michigan Ave., Suite 308
Kalamazoo, MI 49007-6403
P: 269.381.4880 | F: 269.381.9110
www.kingscott.com



Strategic Energy Solutions
4000 West Eleven Mile Road, Berley, MI 48072
Phone 248.399.1900 Fax 248.399.1901
www.sesnet.com

Barton
Malow

Saline Area Schools
2017 Projects
Woodland Meadow Elementary
Saline, Michigan

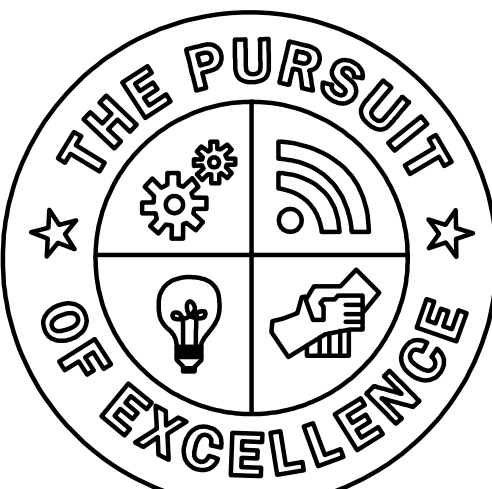

Saline
Area Schools

REVISIONS/REVIEW DATE
ISSUED FOR BID 01-06-2017

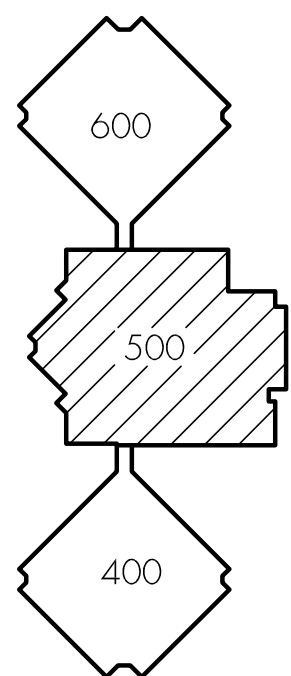

JOB NO. 2900-03



SHEET TITLE

DEMOLITION PLAN - UNIT 500

SHEET NO.

WM-D1.2

KINGSCOTT ASSOCIATES INC. KALAMAZOO, MICHIGAN



Strategic Energy Solutions
4000 West Eleven Mile Road Berley, MI 48072
Phone 248.399.1900 Fax 248.399.1901
www.sesnet.com

**Barton
Malow**

Saline Area Schools
2017 Projects
Woodland Meadow Elementary
Saline, Michigan

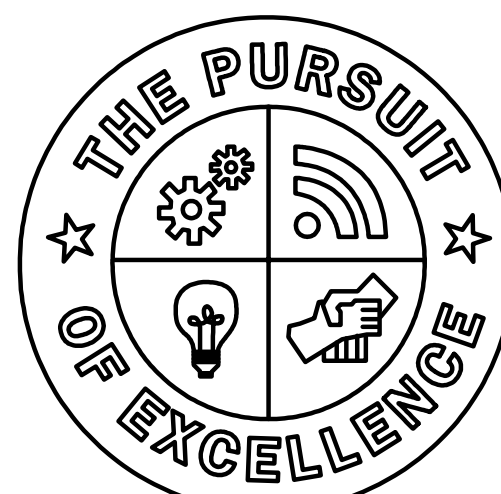

Saline
Area Schools

REVISIONS/REVIEW DATE
ISSUED FOR BID 01-06-2017

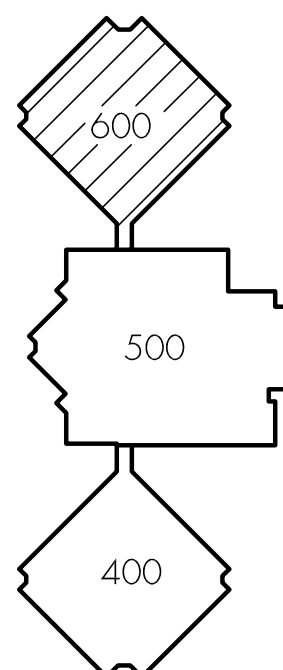

JOB NO. 2900-03



SHEET TITLE

DEMOLITION PLAN - UNIT 600

SHEET NO.

WM-D1.3

© KINGSKOTT ASSOCIATES INC. KALAMAZOO, MICHIGAN

ARCHITECTURAL GENERAL DEMOLITION NOTES

1. THE DEMOLITION PLANS GENERALLY INDICATE AREAS OF EXTENSIVE REMOVALS AND DO NOT INDICATE ALL OF THE WORK. CONTRACTOR SHALL PERFORM ALL THE DEMOLITION WHICH IS NECESSARY FOR THE PROPER EXECUTION OF THE PROJECT, WHETHER OR NOT SAID DEMOLITION IS SPECIFICALLY INDICATED WITHIN THE DOCUMENTS.
2. CONTRACTOR IS RESPONSIBLE TO COORDINATE WITH ALL OTHER DRAWINGS AND SPECIFICATIONS FOR OTHER AREAS THAT WILL REQUIRE DEMOLITION NOT INDICATED ON THESE SHEETS.
3. CONTRACTOR IS RESPONSIBLE TO INFILL, PATCH AND/OR REPAIR EXISTING WALLS, FLOORS AND CEILINGS TO MATCH EXISTING WHERE DEMOLITION OCCURS OTHER THAN AS DESCRIBED IN THESE DOCUMENTS.
4. IT IS THE INTENTION OF THESE DOCUMENTS THAT THE DEMOLITION OF PORTIONS OF MASONRY WALLS (BOTH INTERIOR AND EXTERIOR) ARE GENERALLY TO BE DONE ALONG JOINT AND CORRSING LINES.
5. PATCH AND REPAIR REMAINING ADJACENT SURFACES AT AREAS OF REMOVAL AND/OR ALTERATION TO MATCH EXISTING. PROVIDE A SOUND AND PROPER SUBSTRATE FOR NEW FINISH. COORDINATE WITH COLOR PLANS. WHERE A NEW FINISH IS NOT INDICATED, MATCH EXISTING ADJACENT FINISHES.
6. ALL DEMOLITION IS TO BE DONE WITH REASONABLE CARE AS TO MINIMIZE DAMAGE TO EXISTING REMAINING SURFACES. CONTRACTOR IS RESPONSIBLE TO PROPERLY DISPOSE OF ALL DEMOLISHED ITEMS NOT INDICATED TO BE RELOCATED OR TURNED OVER TO OWNER.
7. PRIOR TO DEMOLITION, CONTRACTOR SHALL COORDINATE ALL ITEMS TO BE SALVAGED FOR REUSE ON THE PROJECT AND/OR RETURNED TO THE OWNER THRU THE CONSTRUCTION MANAGER. A FINAL LIST OF ITEMS SHALL BE COMPLETED BEFORE CONSTRUCTION BEGINS. ALL SUCH ITEMS SHALL BE REMOVED AND PROPERLY PACKED AND STORED TO MAINTAIN AS FOUND CONDITION.
8. COORDINATE DEMOLITION WORK FOR DOOR AND FRAMES WITH DOOR SCHEDULE.
9. CLEAN AND PREPARE ALL EXISTING SURFACES WHICH ARE TO BE PAINTED/ PATCHED. PREPARATION TO INCLUDE MINOR PATCHING. COORDINATE WITH COLOR PLANS FOR LOCATIONS.
10. PROVIDE TEMPORARY SHORING, BRACING, AND/OR SUPPORTS AS REQUIRED FOR WALL AND/OR ROOF AT AREAS OF REMOVAL AND ALTERATION.
11. COORDINATE WITH MECHANICAL AND ELECTRICAL DRAWINGS FOR FURTHER DEMOLITION NOTES.
12. PAINT TO MATCH ADJACENT SURFACES AT AREAS DISTURBED BY MECHANICAL OR ELECTRICAL DEMOLITION, U.N.O.
13. COORDINATE WITH TECHNOLOGY DRAWINGS FOR FURTHER DEMOLITION NOTES.

ARCHITECTURAL DEMOLITION NOTES

- 1 FLOORS
A REMOVE AND PROPERLY DISPOSE OF VCT AND RUBBER BASE. PREP SUB-FLOOR TO BE SUITABLE FOR NEW FLOOR FINISH INSTALLATION.
- 2 WALLS
A REMOVE AND CLEAN MASONRY GROUT JOINTS WHERE MASONRY SETTLED AND JOINTS WERE COMPROMISED.
- 3 CEILINGS
A X
- 4 DOORS & WINDOWS
A REMOVE AND DISPOSE OF EXTERIOR DOOR, INCLUDING FRAME, SIDELIGHTS, LOUVERS AND ALL RELATED ANCHORS, SUPPORTS AND HARDWARE. SAWCUT FRAME ANCHORS, PRYING ANCHORS FROM SUBSTRATES IS UNACCEPTABLE. PREP OPENING FOR NEW DOOR FRAME AND DOOR INSTALLATION.
- 5 TOILETS
A REMOVE AND SALVAGE TOILET FOR REINSTALLATION- REFER TO PLUMBING DEMO PLANS. PREP REMAINING SURFACES TO RECEIVE NEW CONSTRUCTION AND/OR FINISHES. TOILETS TO BE REINSTALLED AFTER NEW FLOORING INSTALL.
- 6 CASEWORK
A REMOVE AND PROPERLY DISPOSE OF COUNTERTOP & BACKSPLASH, INCLUDING ALL ANCHORS, ATTACHMENTS, ETC. PREP EXISTING FINISHES TO RECEIVE NEW TOP. REMOVE AND SALVAGE EXISTING SINK AND FAUCET FOR REINSTALLATION.

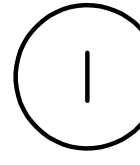
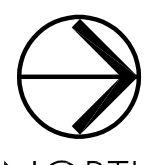
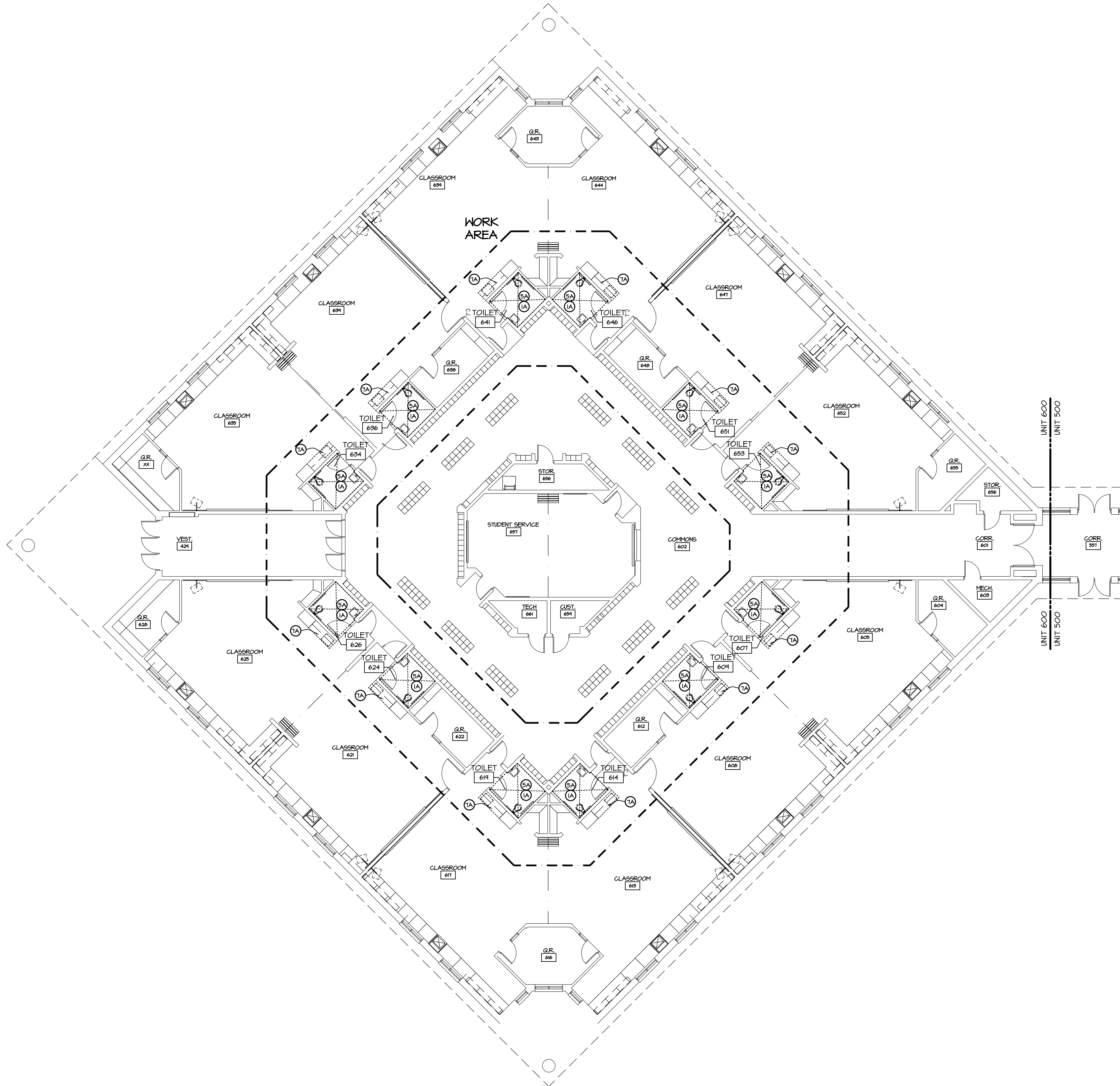

DEMOLITION PLAN - UNIT 600

SCALE: 1/8" = 1'-0"

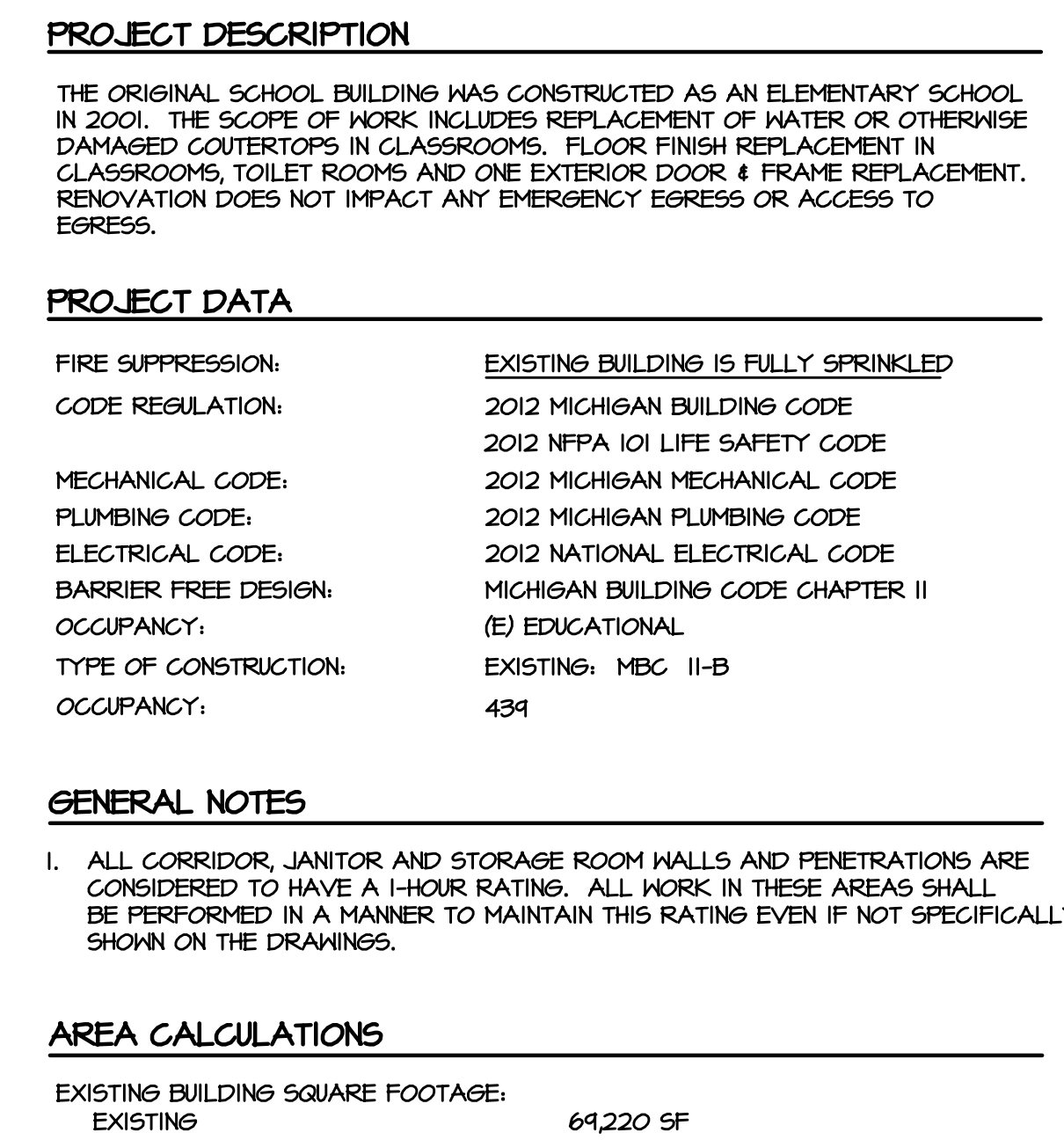

Kingscott

KALAMAZOO | GRAND RAPIDS | CHELSEA
259 East Michigan Ave., Suite 308
Kalamazoo, MI 49007-6403
P: 269.381.4880 | F: 269.381.9110
www.kingscott.com



Strategic Energy Solutions®
4000 West Eleven Mile Road Berkley, MI 48072
Phone 248.399.1900 Fax 248.399.1901
www.sesnet.com

Barton
Malow

Saline Area Schools
2017 Projects
Woodland Meadow Elementary
Saline, Michigan

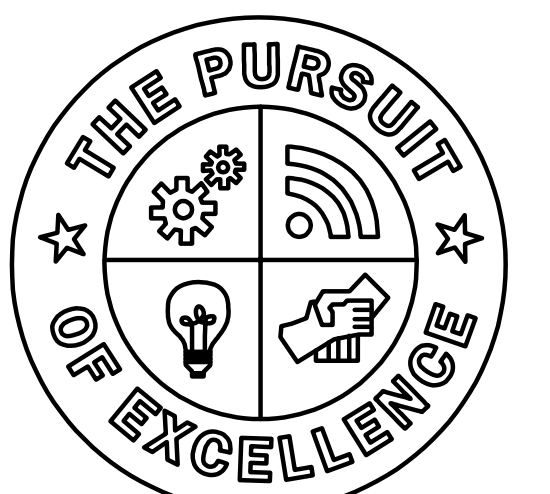

Saline
Area Schools

REVISIONS/REVIEW	DATE
ISSUED FOR BID	01-06-2017

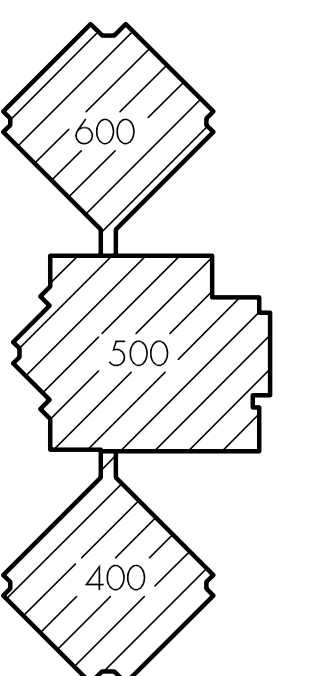

JOB NO. 2900-03

SHEET TITLE

COMPOSITE FLOOR PLAN

SHEET NO.

WM-A0.1

© KINGSCOTT ASSOCIATES INC. KALAMAZOO, MICHIGAN

2 FIRST FLOOR PLAN AREA 500 AND 600
SCALE: 1/16" = 1'-0"

PARTIAL DOOR SCHEDULE-UNIT 500													
OPNG	DOOR				FRAME							LABEL	REMARKS
	SIZE	TYPE	MAT	GLASS	TYPE	MAT	GLASS	HEAD	JAMB	JAMB	SILL		
541A	EXISTING	NG	FRP	GL-1	I	AL	-	3/4"x4-1/3"	-	2"x4-1/3"	1/4"x4-1/3"	-	-

NOTE: REFER TO SPECIFICATIONS FOR HARDWARE
PROVIDE ADJUSTABLE DOOR BOTTOM

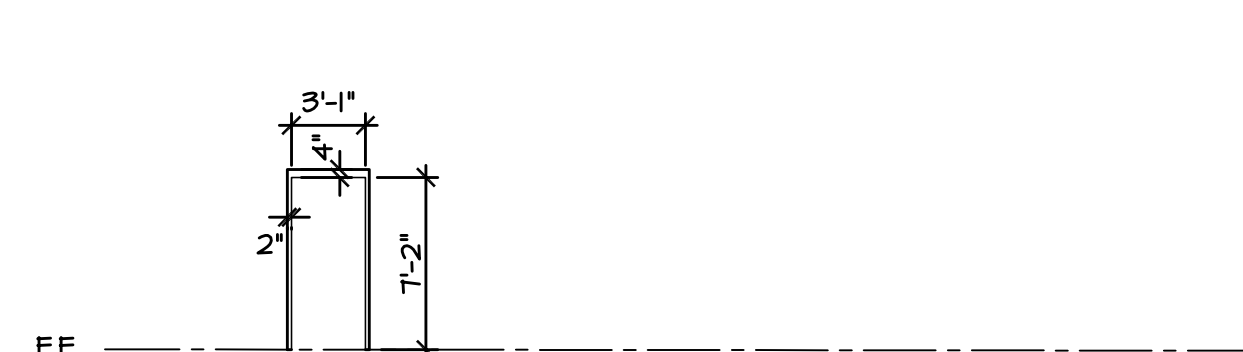

DOOR FRAME TYPES

NOTE: CONTRACTOR SHALL VERIFY ALL ROUGH OPENINGS IN FIELD PRIOR TO MANUFACTURE OF FRAMES.

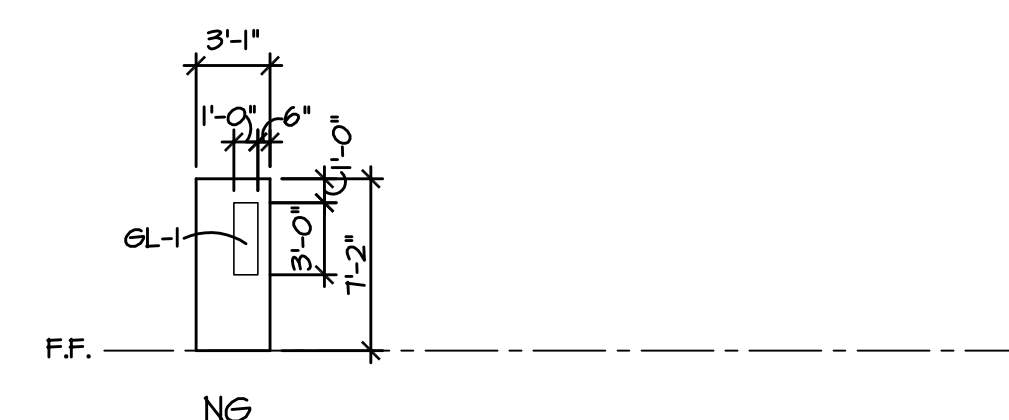



DOOR TYPES:

GL-1: 1" CLEAR INSULATED, TEMPERED, 1/4" INNER AND OUTER LITE
1/2" AIR SPACE.

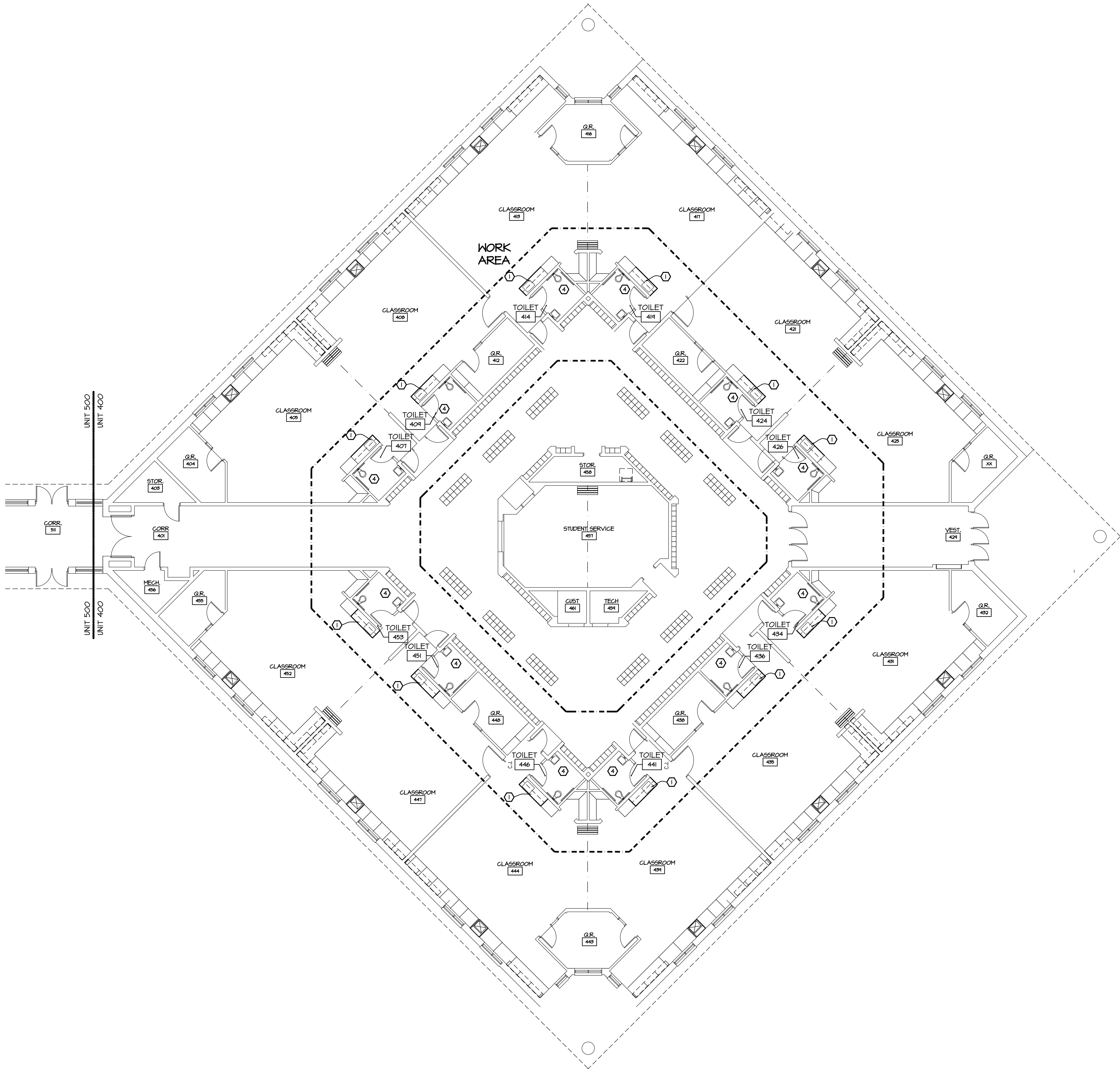



  **FLOOR PLAN - UNIT 400**
SCALE: 1/8" = 1'-0"

- GENERAL NOTES**
1.  INDICATES CONSTRUCTION DOCUMENTS ROOM NUMBERS.
 2.  INDICATES DOOR. REFER TO FRAME TYPES FOR EXTERIOR DOOR & STOREFRONT SIZES. REFER TO SHEET WM-A1.0 FOR DOOR SCHEDULE AND DETAILS.
 3. REFER TO DEMOLITION PLANS FOR ADDITIONAL NOTES REGARDING PATCHING AT AREAS OF REMOVAL AND/OR ALTERATIONS. COORDINATE WITH MECHANICAL, ELECTRICAL, AND PLUMBING CONTRACTORS.
 4. CONTRACTOR SHALL FIELD VERIFY ALL DIMENSIONS LISTED AS "MATCH EXISTING", "EXISTING", OR PLUS OR MINUS (±).
 5. REFER TO SHEET #12 FOR FLOOR PLAN SYMBOLS LEGEND.
 6. FILL/SEAL ALL PENETRATIONS, INCLUDING OPENINGS WHERE PIPING AND DUCTWORK WAS REMOVED, THROUGH WALLS AND VOIDS AT STRUCTURAL MEMBERS. USE FIRE RATED PATCHING MATERIALS IN RATED WALLS IDENTIFIED ON THE GODE COMPOSITE PLAN. USE CMU WHERE REQUIRED TO MATCH ADJACENT CONSTRUCTION.
 7. ALL PARTITIONS TO RUN TIGHT TO DECK UNO.
 8. REFER TO EQUIPMENT PLANS FOR CASEWORK, VISUAL DISPLAY BOARDS, LOCKERS, SHELVING, ETC.
 9. ALL NEW MASONRY ABUTTING EXISTING MASONRY SHALL BE TOOTHED INTO EXISTING MASONRY.
 10. WHERE THE NOTE "PREP SURFACES" IS ENCOUNTERED, THE CONTRACTOR SHALL TAKE THIS TO MEAN ALL GLUES, RESIDUES, MASTICS, PROTRUSIONS, PITTING, AND MISSING SUBSTRATE MATERIAL SHALL BE REMOVED.

- KEY NOTES:**
1. REPLACE 61. COUNTERTOP & BACKSPASH ON EXISTING BASE CABINETS. VERIFY ALL DIMENSIONS IN FIELD. EXISTING SINK TO BE RE-INSTALLED. NEW COUNTERTOP LAMINATE TO MATCH EXISTING COLOR WITH 3MM PVC EDGE. SEE SPEC. SECTION 123216 & 123623.16.
 2. CLEAN / REMOVE GROUT FROM DAMAGED CMU MASONRY JOINT. PROVIDE FOAM BACKER ROD IN PORTION OF JOINT WHERE APPLICATION OF SEALANT REQUIRES. APPLY BUTYL BASED, NON-USE, NON-HARDENING PAINTABLE SEALANT. PAINT WALL TO MATCH ADJACENT FINISH, AFTER SEALANT CURES. REFER TO IMAGE #2, THIS SHEET FOR SOUTH WALL OF GYM REFER TO IMAGE #3, THIS SHEET FOR NORTH WALL OF CORRIDOR 525
 3. PROVIDE NEW DOOR AND FRAME IN EXISTING OPENING. REFER TO DOOR SCHEDULE ON SHEET WM-A01.
 4. REMOVE EXISTING VCT FLOORING, PREPARE SUBFLOOR TO BE SUITABLE FOR NEW FLOOR FINISH INSTALLATION. COORDINATE WITH INTERIOR DRAWINGS. REMOVE AND REINSTALL EXISTING FLOOR MOUNTED TOILETS WHERE THIS OCCURS, AFTER NEW FLOORING INSTALLATION.

Kingscott

KALAMAZOO | GRAND RAPIDS | CHELSEA
259 East Michigan Ave., Suite 308
Kalamazoo, MI 49007-6403
P: 269.381.4880 | F: 269.381.9110
www.kingscott.com



Strategic Energy Solutions
4000 West Eleven Mile Road, Berley, MI 48072
Phone 248.399.1900 Fax 248.399.1901
www.sesnet.com

Barton Malow

Saline Area Schools
2017 Projects
Woodland Meadow Elementary
Saline, Michigan

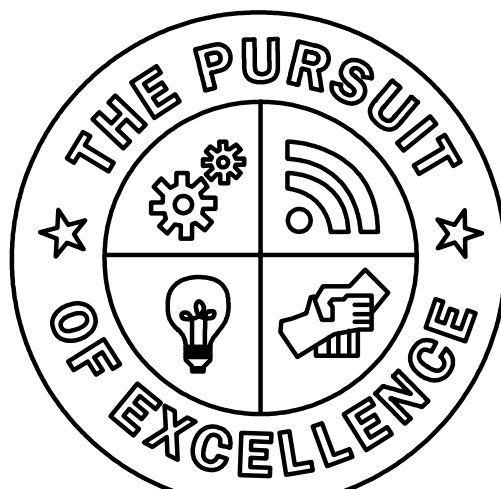

Saline Area Schools

REVISIONS/REVIEW	DATE
ISSUED FOR BID	01-06-2017

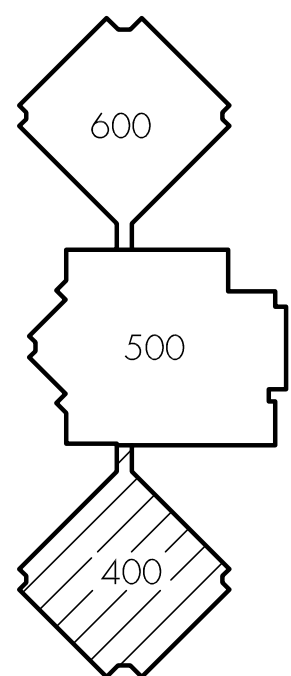

JOB NO. 2900-03



SHEET TITLE

FLOOR PLAN - UNIT 400

SHEET NO.

WM-A1.1

© KINGSKOTT ASSOCIATES INC. KALAMAZOO, MICHIGAN

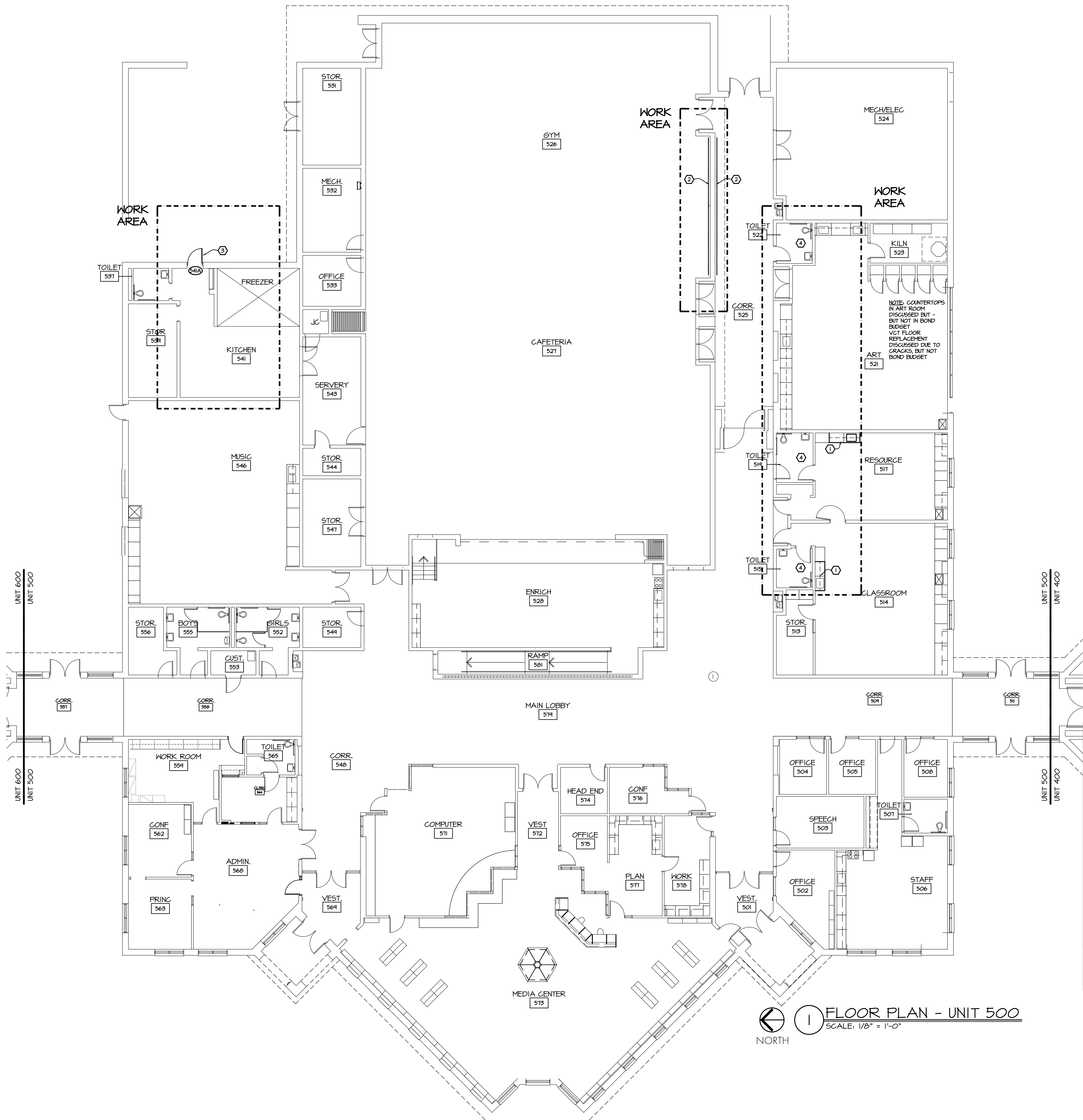

1 FLOOR PLAN - UNIT 500
SCALE: 1/8" = 1'-0"

- GENERAL NOTES**
- XXXX INDICATES CONSTRUCTION DOCUMENTS ROOM NUMBERS.
 - INDICATES DOOR, REFER TO FRAME TYPES FOR EXTERIOR DOOR & STOREFRONT SIZES. REFER TO SHEET WM-A1.0 FOR DOOR SCHEDULE AND DETAILS.
 - REFER TO DEMOLITION PLANS FOR ADDITIONAL NOTES REGARDING PATCHING AT AREAS OF REMOVAL, AND/OR ALTERATIONS. COORDINATE WITH MECHANICAL, ELECTRICAL, AND PLUMBING CONTRACTORS.
 - CONTRACTOR SHALL FIELD VERIFY ALL DIMENSIONS LISTED AS "MATCH EXISTING", "EXISTING", OR PLUS OR MINUS (±).
 - REFER TO SHEET #12 FOR FLOOR PLAN SYMBOLS LEGEND.
 - FILL/SEAL ALL PENETRATIONS, INCLUDING OPENINGS WHERE PIPING AND DUCTWORK HAS BEEN REMOVED, THROUGH WALLS AND VOIDS AT STRUCTURAL MEMBERS. USE FIRE RATED PATCHING MATERIALS IN RATED WALLS IDENTIFIED ON THE CODE COMPOSITE PLAN. USE CMU WHERE REQUIRED TO MATCH ADJACENT CONSTRUCTION.
 - ALL PARTITIONS TO RUN TIGHT TO DECK UNO.
 - REFER TO EQUIPMENT PLANS FOR CASEWORK, VISUAL DISPLAY BOARDS, LOCKERS, SHELVING, ETC.
 - ALL NEW MASONRY ABUTTING EXISTING MASONRY SHALL BE TOOTHED INTO EXISTING MASONRY.
 - WHERE THE NOTE "PREP SURFACES" IS ENCOUNTERED, THE CONTRACTOR SHALL TAKE THIS TO MEAN ALL GLUES, RESIDUES, MASTICS, PROTRUSIONS, PITTING, AND MISSING SUBSTRATE MATERIAL SHALL BE REMOVED.

- KEY NOTES:**
- REPLACE 6" COUNTERTOP & BACKSPLASH ON EXISTING BASE CABINETS. VERIFY ALL DIMENSIONS IN FIELD. EXISTING SINK TO BE RE-INSTALLED. NEW COUNTERTOP LAMINATE TO MATCH EXISTING COLOR WITH 3MM PVC EDGE. SEE SPEC. SECTION 123016 & 123020.
 - CLEAN / REMOVE GROUT FROM DAMAGED CMU MASONRY JOINT. PROVIDE FOAM BACKER ROD IN PORTION OF JOINT WHERE APPLICATION OF SEALANT REQUIRES. APPLY BUTYL BASED, NON-JAG, NON-HARDENING PAINTABLE SEALANT. PAINT WALL TO MATCH ADJACENT FINISH, AFTER SEALANT CURES. REFER TO IMAGE #2, THIS SHEET FOR SOUTH WALL OF GYM. REFER TO IMAGE #3, THIS SHEET FOR NORTH WALL OF CORRIDOR 525.
 - PROVIDE NEW DOOR AND FRAME IN EXISTING OPENING. REFER TO DOOR SCHEDULE ON SHEET WM-A0.1.
 - REMOVE EXISTING VGT FLOORING; PREPARE SUBFLOOR TO BE SUITABLE FOR NEW FLOOR FINISH INSTALLATION. COORDINATE WITH INTERIOR DRAWINGS. REMOVE AND REINSTALL EXISTING FLOOR MOUNTED TOILETS WHERE THIS OCCURS, AFTER NEW FLOORING INSTALLATION.



3 GYM SOUTH WALL
NO SCALE



2 CORRIDOR 525 NORTH WALL
NO SCALE

Kingscott
KALAMAZOO | GRAND RAPIDS | CHELSEA
259 East Michigan Ave., Suite 308
Kalamazoo, MI 49007-6403
P: 269.381.4880 | F: 269.381.9110
www.kingscott.com

SES
Strategic Energy Solutions
4000 West Eleven Mile Road, Berley, MI 48072
Phone 248.399.1900 Fax 248.399.1901
www.sesnet.com

Barton Malow

Saline Area Schools
2017 Projects
Woodland Meadow Elementary
Saline, Michigan

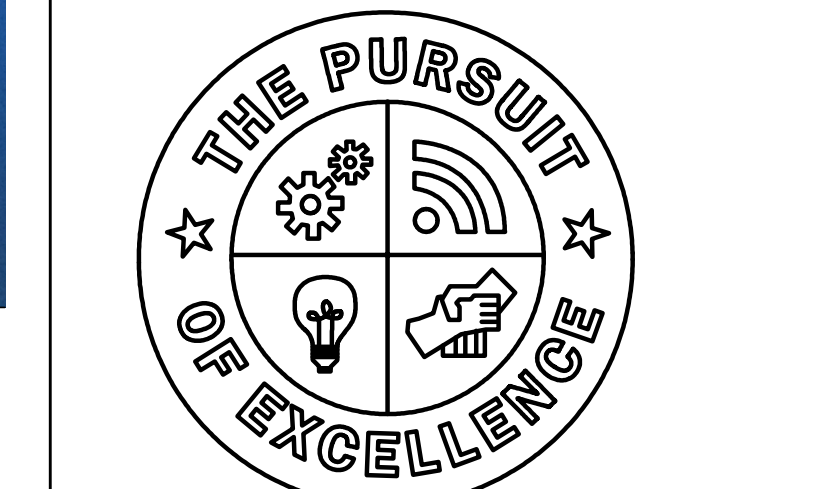

Saline Area Schools

REVISIONS/REVIEW	DATE
ISSUED FOR BID	01-06-2017

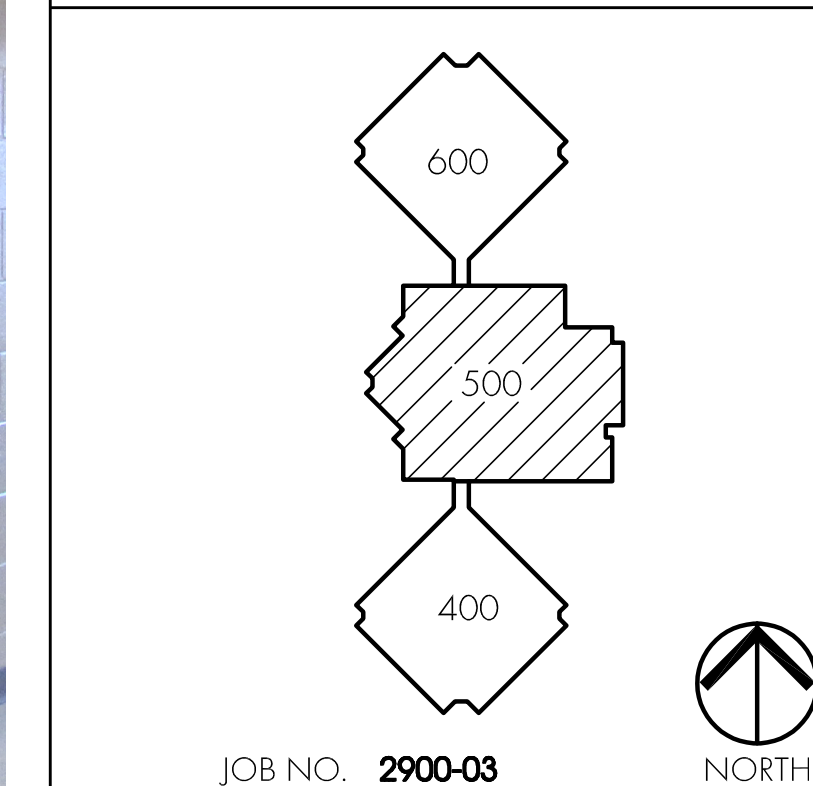

JOB NO. **2900-03**
SHEET TITLE
FLOOR PLAN - UNIT 500

SHEET NO.
WM-A1.2
© KINGSKOTT ASSOCIATES INC. KALAMAZOO, MICHIGAN



Strategic Energy Solutions
4000 West Eleven Mile Road, Berley, MI 48072
Phone 248.399.1900 Fax 248.399.1901
www.sesnet.com

Barton Malow

Saline Area Schools
2017 Projects
Woodland Meadow Elementary
Saline, Michigan

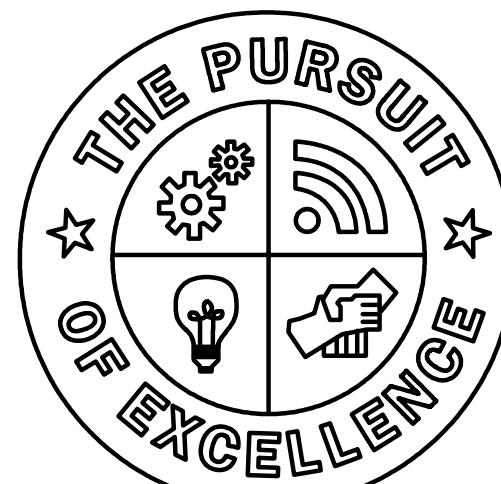

Saline
Area Schools

REVISIONS/REVIEW DATE
ISSUED FOR BID 01-06-2017

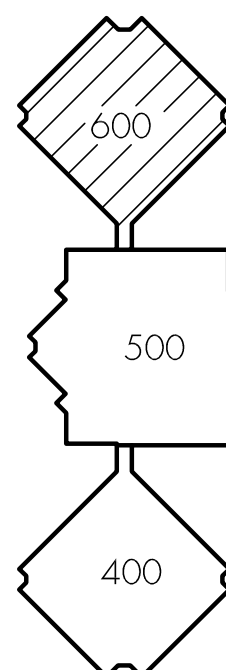

JOB NO. 2900-03

SHEET TITLE

FLOOR PLAN - UNIT 600

SHEET NO.

WM-A1.3

© KINGSKOTT ASSOCIATES INC. KALAMAZOO, MICHIGAN

GENERAL NOTES

- XXXX INDICATES CONSTRUCTION DOCUMENTS ROOM NUMBERS.
- INDICATES DOOR. REFER TO FRAME TYPES FOR EXTERIOR DOOR & STOREFRONT SIZES. REFER TO SHEET WM-A1.0 FOR DOOR SCHEDULE AND DETAILS.
- REFER TO DEMOLITION PLANS FOR ADDITIONAL NOTES REGARDING PATCHING AT AREAS OF REMOVAL AND/OR ALTERATIONS. COORDINATE WITH MECHANICAL, ELECTRICAL, AND PLUMBING CONTRACTORS.
- CONTRACTOR SHALL FIELD VERIFY ALL DIMENSIONS LISTED AS "MATCH EXISTING", "EXISTING", OR PLUS OR MINUS (±).
- REFER TO SHEET #12 FOR FLOOR PLAN SYMBOLS LEGEND.
- FILL/SEAL ALL PENETRATIONS, INCLUDING OPENINGS WHERE PIPING AND DUCTWORK HAS REMOVED, THROUGH WALLS AND VOIDS AT STRUCTURAL MEMBERS. USE FIRE RATED PATCHING MATERIALS IN RATED WALLS IDENTIFIED ON THE CODE COMPOSITE PLAN. USE CMU WHERE REQUIRED TO MATCH ADJACENT CONSTRUCTION.
- ALL PARTITIONS TO RUN TIGHT TO DECK UNO.
- REFER TO EQUIPMENT PLANS FOR CASEWORK, VISUAL DISPLAY BOARDS, LOCKERS, SHELVING, ETC.
- ALL NEW MASONRY ABUTTING EXISTING MASONRY SHALL BE TOOTHED INTO EXISTING MASONRY.
- WHERE THE NOTE "PREP SURFACES" IS ENCOUNTERED, THE CONTRACTOR SHALL TAKE THIS TO MEAN ALL GLUES, RESIDUES, MASTICS, PROTRUSIONS, FITTING, AND MISSING SUBSTRATE MATERIAL SHALL BE REMOVED

KEY NOTES:

- REPLACE 6" COUNTERTOP & BACKSPLASH ON EXISTING BASE CABINETS. VERIFY ALL DIMENSIONS IN FIELD. EXISTING SINK TO BE RE-INSTALLED. NEW COUNTERTOP LAMINATE TO MATCH EXISTING COLOR WITH 3MM PVC EDGE. SEE SPEC. SECTION 123016 & 123629.16.
- CLEAN / REMOVE GROUT FROM DAMAGED CMU MASONRY JOINT. PROVIDE FOAM BACKER ROD IN PORTION OF JOINT WHERE APPLICATION OF SEALANT REQUIRES. APPLY BUTYL BASED, NON-JAG, NON-HARDENING PAINTABLE SEALANT. PAINT WALL TO MATCH ADJACENT FINISH, AFTER SEALANT CURES. REFER TO IMAGE #2, THIS SHEET FOR SOUTH WALL OF 6YM. REFER TO IMAGE #3, THIS SHEET FOR NORTH WALL OF CORRIDOR 525
- PROVIDE NEW DOOR AND FRAME IN EXISTING OPENING. REFER TO DOOR SCHEDULE ON SHEET WM-A01.
- REMOVE EXISTING VGT FLOORING; PREPARE SUBFLOOR TO BE SUITABLE FOR NEW FLOOR FINISH INSTALLATION. COORDINATE WITH INTERIOR DRAWINGS. REMOVE AND REINSTALL EXISTING FLOOR MOUNTED TOILETS WHERE THIS OCCURS, AFTER NEW FLOORING INSTALLATION.

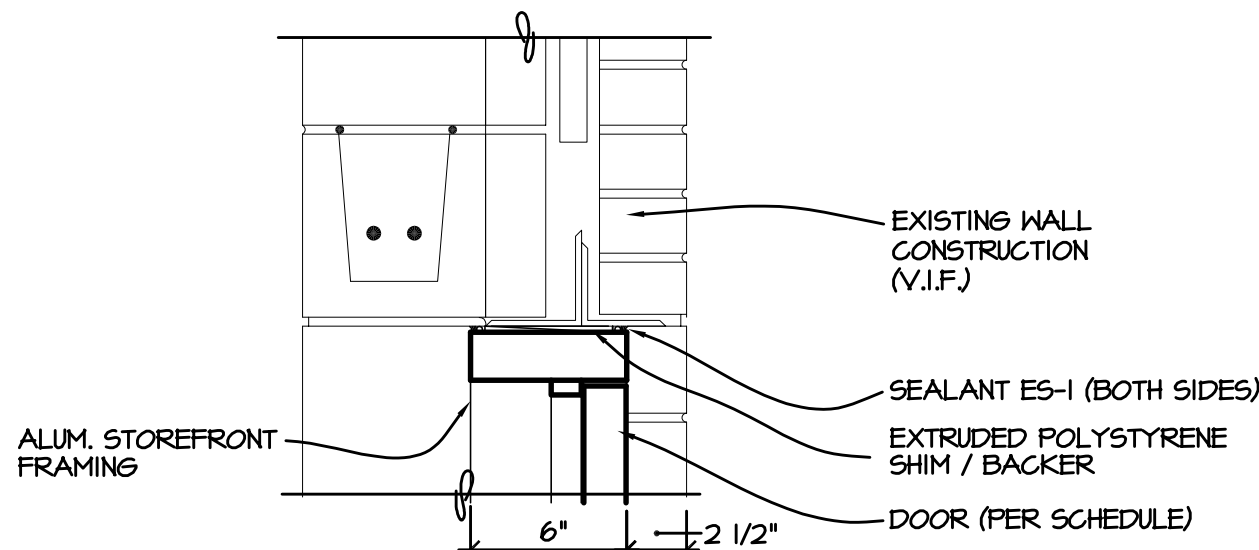

3 HEAD - ALUMINUM 1 1/2"=1'-0"

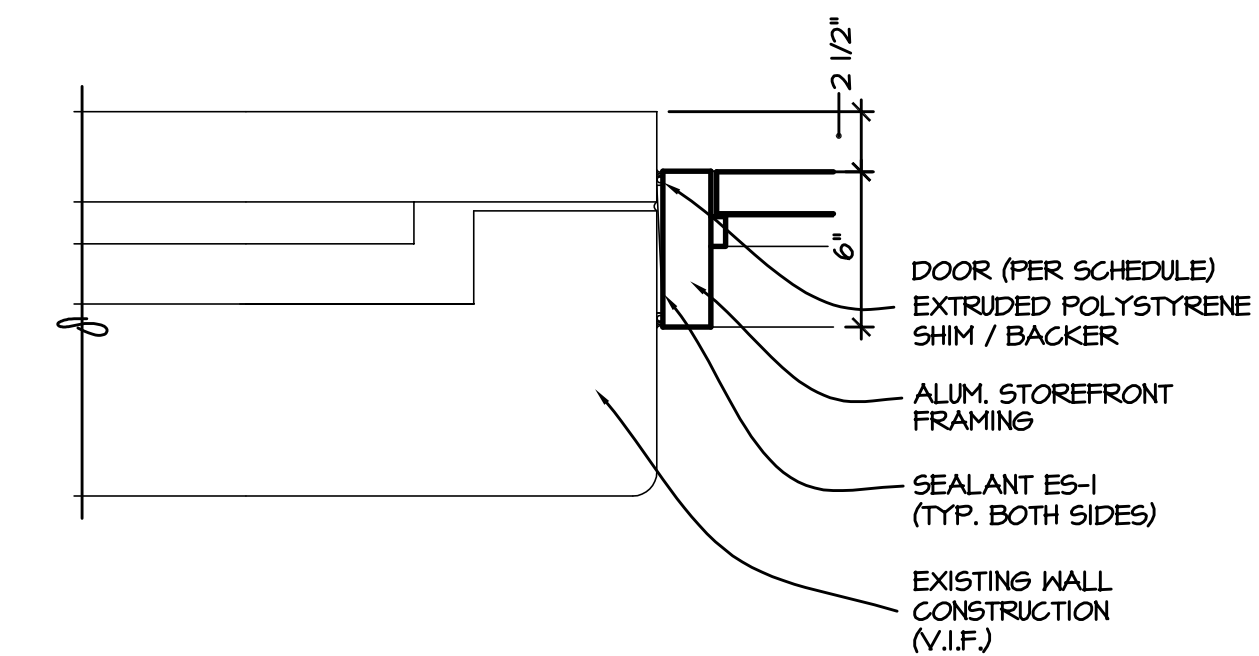

2 JAMB - ALUMINUM 1 1/2"=1'-0"

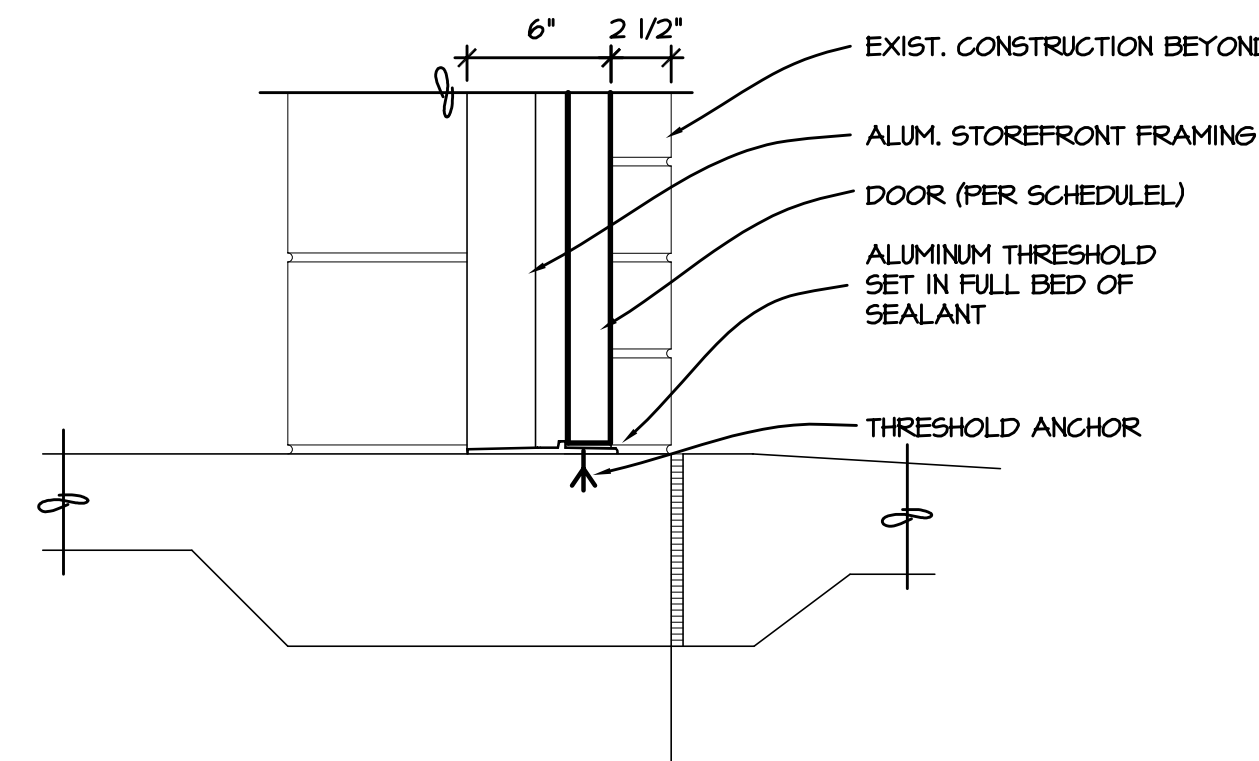

1 SILL - ALUMINUM 1 1/2"=1'-0"

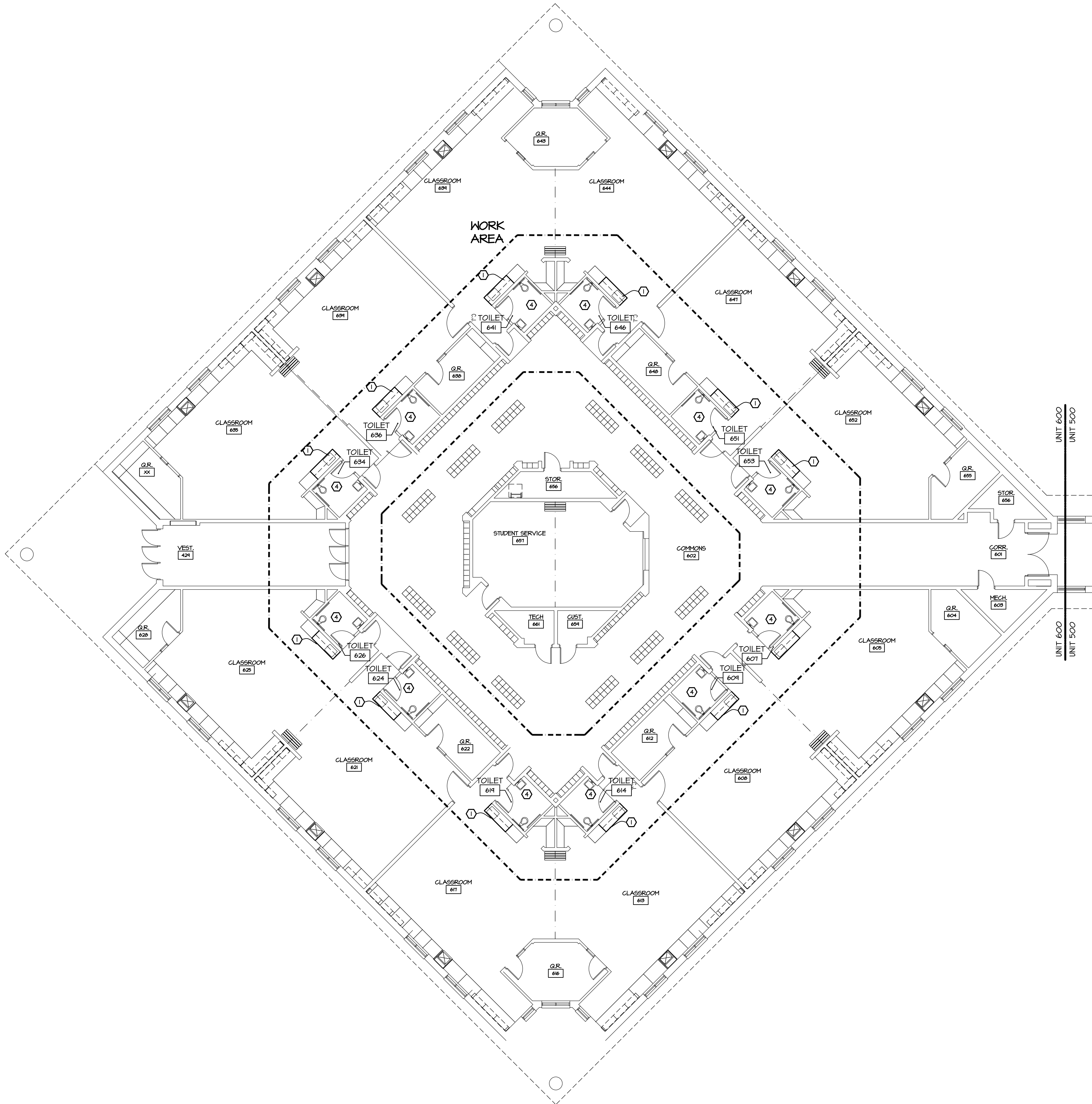

4 FLOOR PLAN - UNIT 600 SCALE: 1/8" = 1'-0"

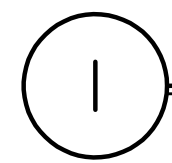
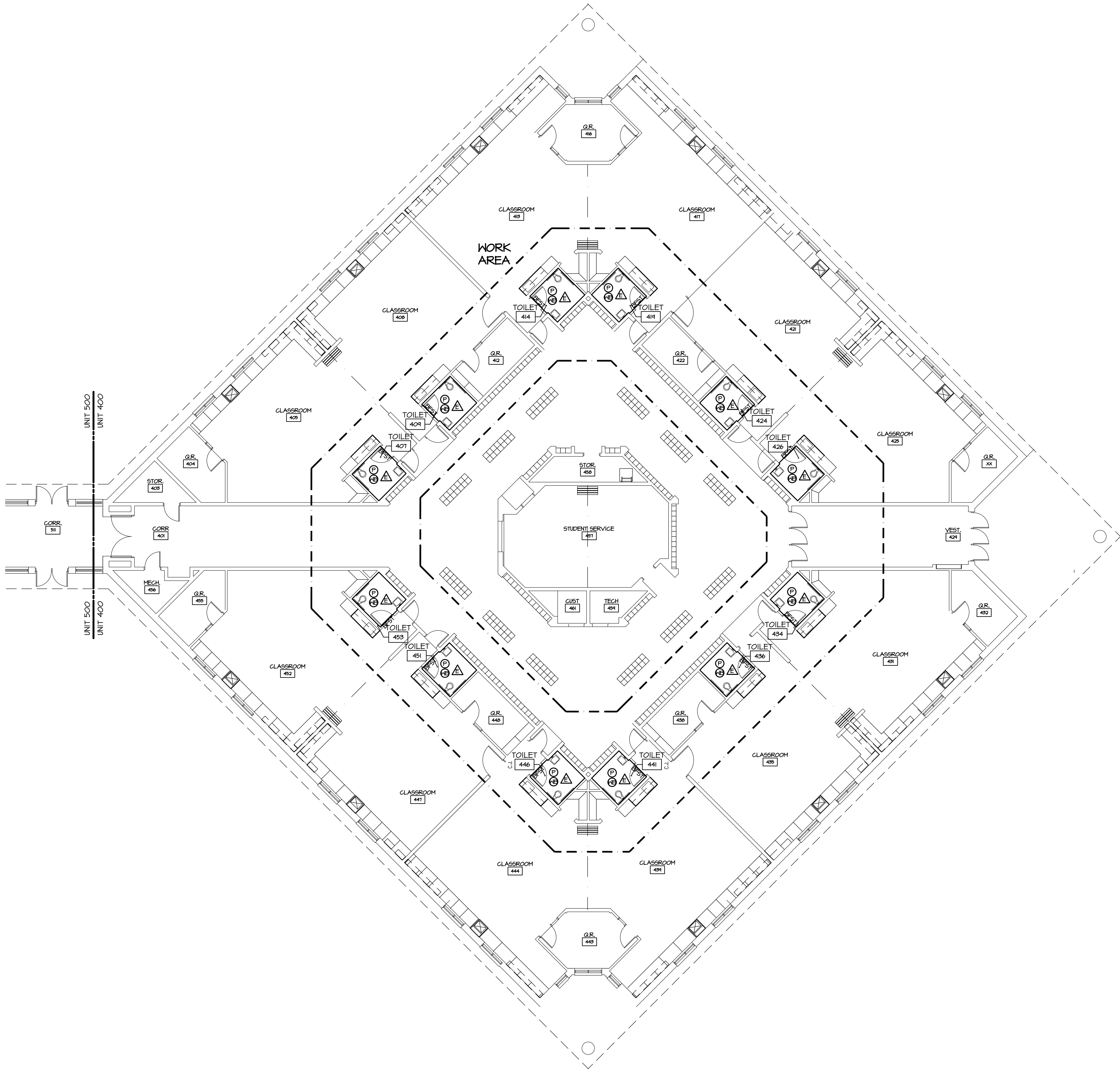

COLOR LAYOUT PLAN - UNIT 400
SCALE: 1/8" = 1'-0"

GENERAL COLOR NOTES

- SEE REFLECTED CEILING PLAN FOR ACOUSTICAL PANEL TYPES.
- IT IS THE RESPONSIBILITY OF ALL TRADES TO COORDINATE PREPARATION OF SURFACES TO RECEIVE FINISH PRODUCT. CONSULT WITH MANUFACTURER'S RECOMMENDED PRACTICES.
- TOUCH-UP PAINT AT ALL CASEWORK COUNTERTOP REPLACEMENTS. PAINT TO MATCH EXISTING, ADJACENT WALL COLOR.
- PROVIDE NEW FLOOR DRAIN COVER AT ALL TOILET ROOM FLOORING REPLACEMENT AREAS.

COLOR LAY-OUT SYMBOL KEY

- CERAMIC TILE FLOOR (CTF)
- P=PATTERN
- CERAMIC TILE BASE (CTB)
- PAINT (P)
- E=MATCH EXISTING PAINT COLOR
- BFST BARRIER FREE STONE THRESHOLD

TYPICAL CERAMIC FLOOR TILE PATTERN (P)

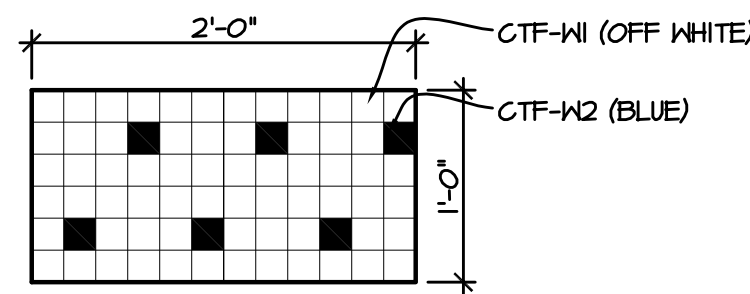

TYPICAL CERAMIC MOSAIC TILE PATTERN

TYPICAL CERAMIC WALL COVE BASE (P)

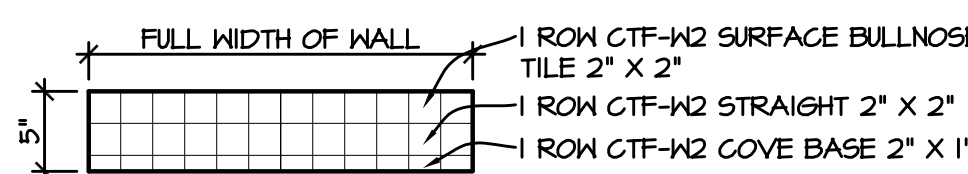

Kingscott

KALAMAZOO | GRAND RAPIDS | CHELSEA
259 East Michigan Ave., Suite 308
Kalamazoo, MI 49007-6403
P: 269.381.4880 | F: 269.381.9110
www.kingscott.com



Strategic Energy Solutions
4000 West Eleven Mile Road, Berley, MI 48072
Phone 248.399.1900 Fax 248.399.1901
www.seenet.com

Barton Malow

Saline Area Schools
2017 Projects
Woodland Meadow Elementary
Saline, Michigan

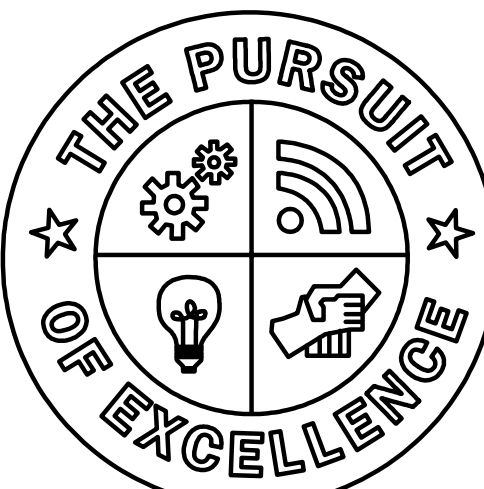

Saline
Area Schools

REVISIONS/REVIEW DATE
ISSUED FOR BID 01-06-2017

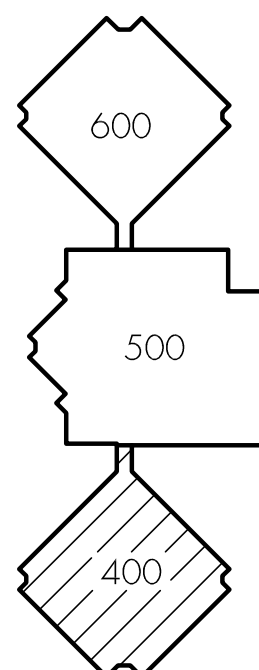

JOB NO. 2900-03



SHEET TITLE

COLOR LAYOUT PLAN - UNIT 400

SHEET NO.

WM-A8.1

© KINGSKOTT ASSOCIATES INC. KALAMAZOO, MICHIGAN

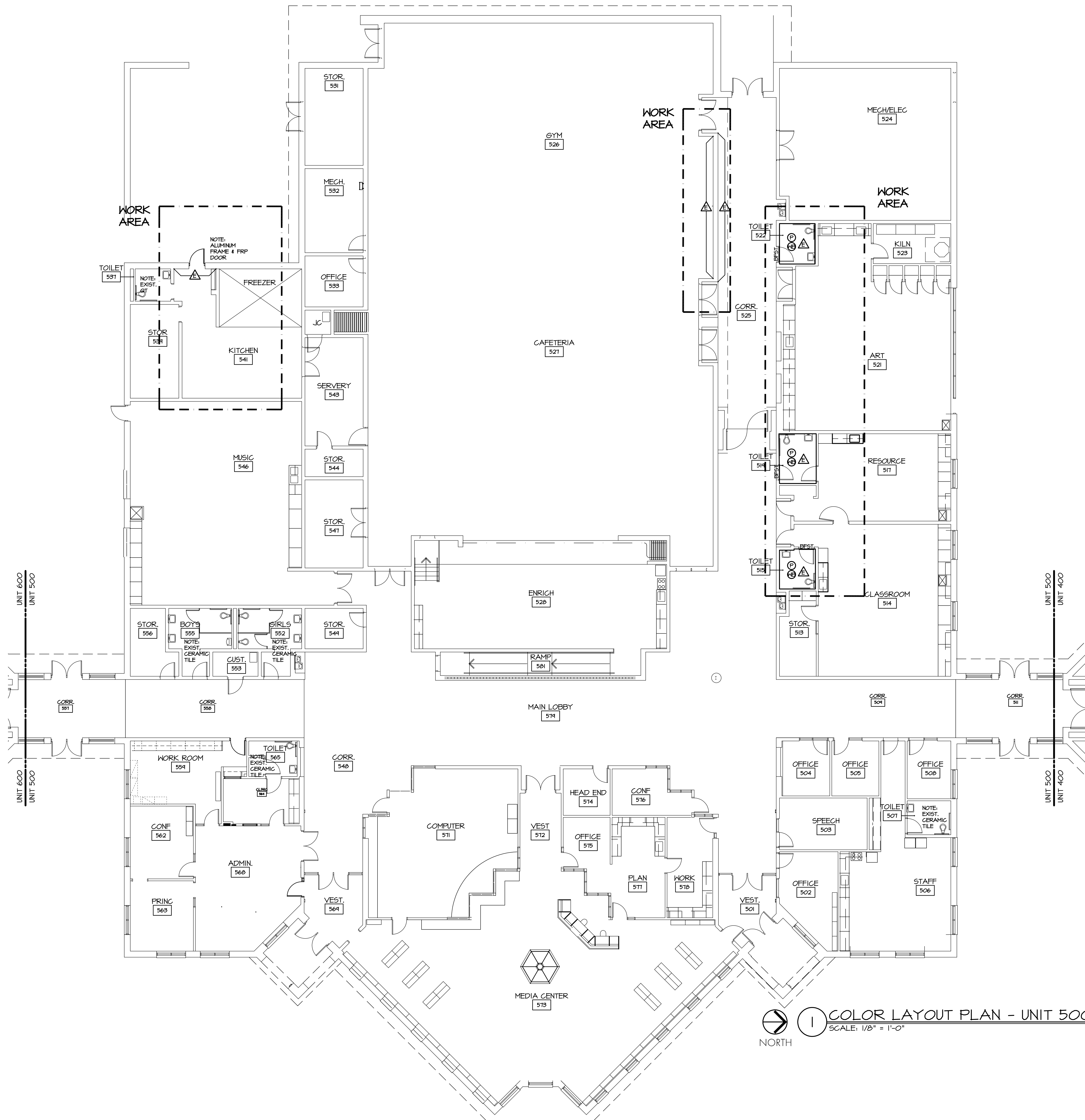

- GENERAL COLOR NOTES**
1. SEE REFLECTED CEILING PLAN FOR ACOUSTICAL PANEL TYPES.
 2. IT IS THE RESPONSIBILITY OF ALL TRADES TO COORDINATE PREPARATION OF SURFACES TO RECEIVE FINISH PRODUCT. CONSULT WITH MANUFACTURER'S RECOMMENDED PRACTICES.
 3. TOUCH-UP PAINT AT ALL CASEWORK COUNTERTOP REPLACEMENTS. PAINT TO MATCH EXISTING, ADJACENT WALL COLOR.
 4. PROVIDE NEW FLOOR DRAIN COVER AT ALL TOILET ROOM FLOORING REPLACEMENT AREAS.

- COLOR LAY-OUT SYMBOL KEY**
- ① CERAMIC TILE FLOOR (CTF)
P=PATTERN
CTB=CERAMIC TILE BASE (CTB)
 - △ PAINT (P)
E=MATCH EXISTING PAINT COLOR
BFT= BARRIER FREE STONE THRESHOLD

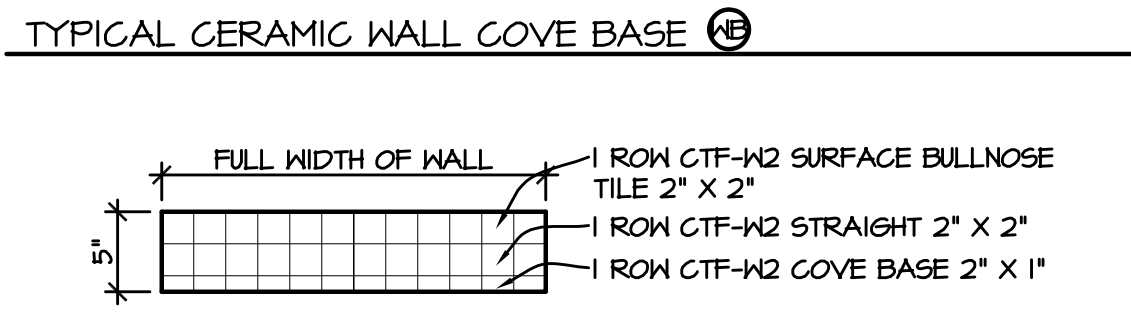
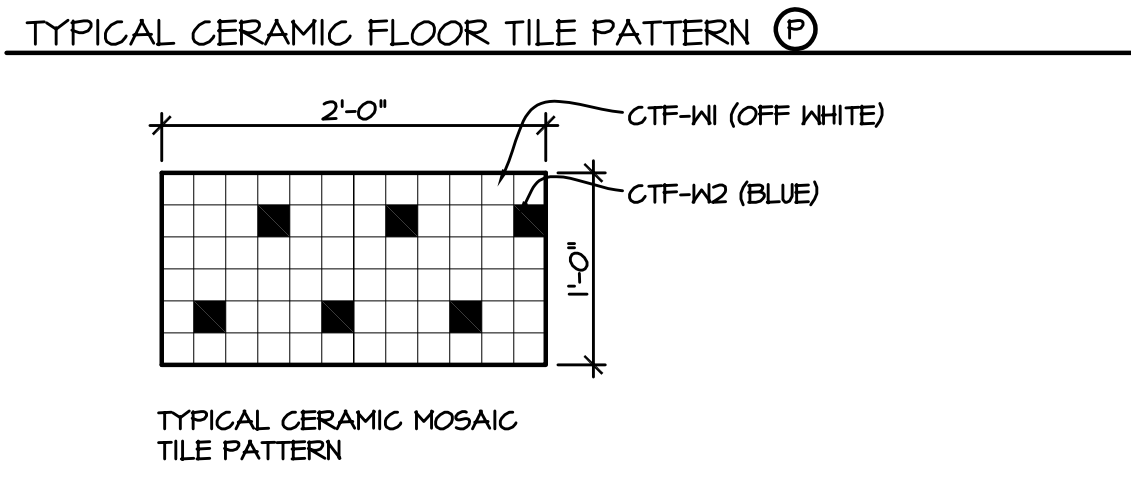

COLOR LAYOUT PLAN - UNIT 500
SCALE: 1/8" = 1'-0"

Kingscott
KALAMAZOO | GRAND RAPIDS | CHELSEA
259 East Michigan Ave., Suite 308
Kalamazoo, MI 49007-6403
P: 269.381.4880 | F: 269.381.9110
www.kingscott.com



Barton Malow

Saline Area Schools
2017 Projects
Woodland Meadow Elementary
Saline, Michigan



Saline Area Schools

REVISIONS/REVIEW	DATE
ISSUED FOR BID	01-06-2017

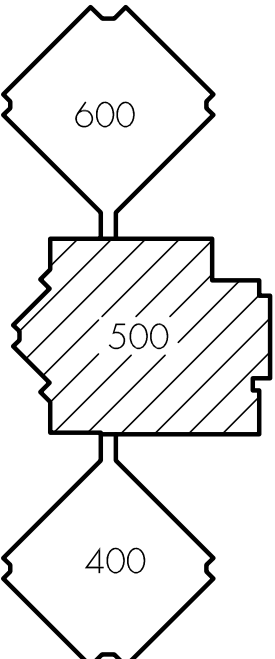

JOB NO. 2900-03

SHEET TITLE

COLOR LAYOUT PLAN - UNIT 500

SHEET NO.





Strategic Energy Solutions
4000 West Eleven Mile Road, Berley, MI 48072
Phone 248.399.1900 Fax 248.399.1901
www.seenet.com

**Barton
Malow**

Saline Area Schools
2017 Projects
Woodland Meadow Elementary
Saline, Michigan

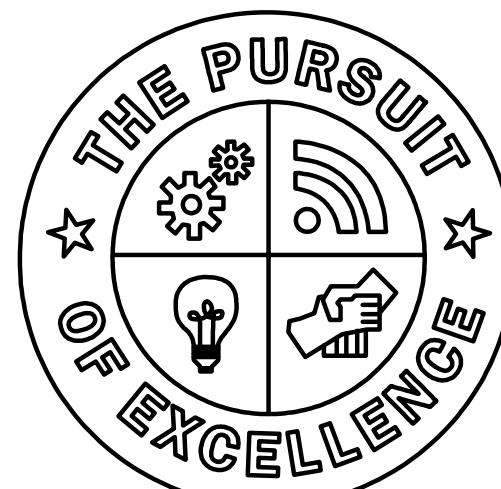

Saline
Area Schools

REVISIONS/REVIEW DATE
ISSUED FOR BID 01-06-2017

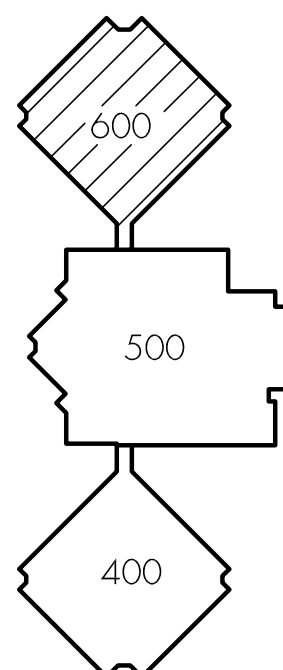

JOB NO. 2900-03



SHEET TITLE

COLOR LAYOUT PLAN - UNIT 600

SHEET NO.

WM-A8.3

© KINGSKOTT ASSOCIATES INC. KALAMAZOO, MICHIGAN

GENERAL COLOR NOTES

- SEE REFLECTED CEILING PLAN FOR ACOUSTICAL PANEL TYPES.
- IT IS THE RESPONSIBILITY OF ALL TRADES TO COORDINATE PREPARATION OF SURFACES TO RECEIVE FINISH PRODUCT. CONSULT WITH MANUFACTURER'S RECOMMENDED PRACTICES.
- TOUCH-UP PAINT AT ALL CASEWORK COUNTERTOP REPLACEMENTS. PAINT TO MATCH EXISTING, ADJACENT WALL COLOR.
- PROVIDE NEW FLOOR DRAIN COVER AT ALL TOILET ROOM FLOORING REPLACEMENT AREAS.

COLOR LAY-OUT SYMBOL KEY

- ① CERAMIC TILE FLOOR (CTF)
- P=PATTERN
- ② CERAMIC TILE BASE (CTB)
- △ PAINT (P)
- E=MATCH EXISTING PAINT COLOR
- BFST BARRIER FREE STONE THRESHOLD

TYPICAL CERAMIC FLOOR TILE PATTERN ②

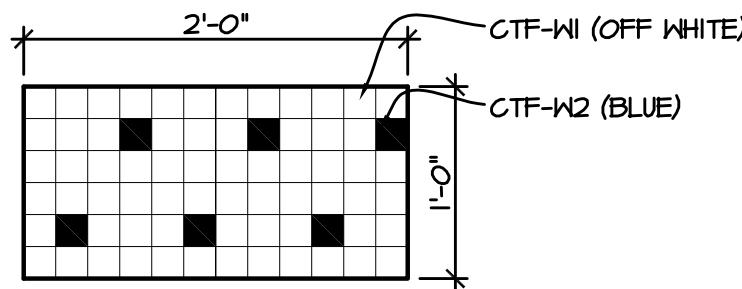

TYPICAL CERAMIC MOSAIC
TILE PATTERN

TYPICAL CERAMIC WALL COVE BASE ②

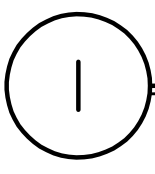
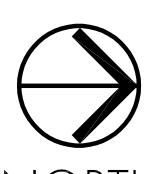
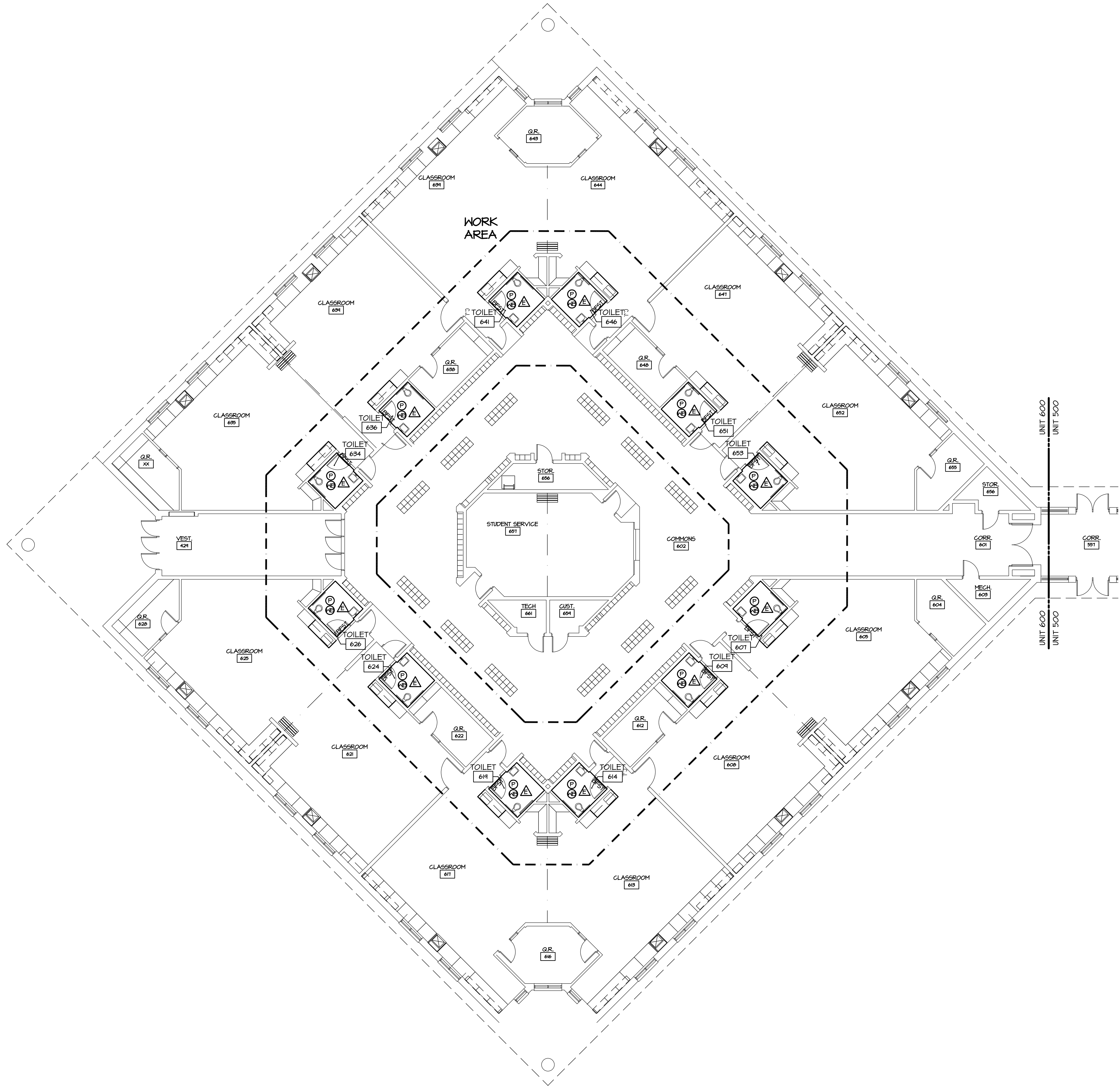
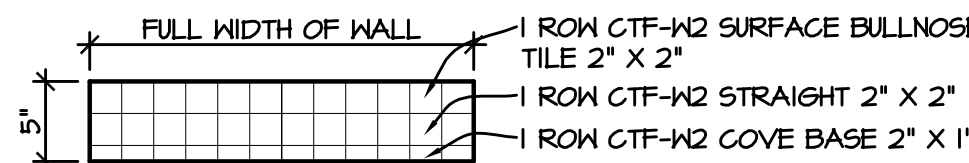

COLOR LAYOUT PLAN - UNIT 600

SCALE: 1/8" = 1'-0"