

FIRE PROTECTION NOTES

1. FIRE PROTECTION CONTRACTOR TO PROVIDE A COMPLETELY SPRINKLED BUILDING (LIGHT HAZARD). DESIGN FIRE PROTECTION SYSTEMS PER NFPA #13, STATE FIRE MARSHALL AND REQUIREMENTS PER CITY CODE.
2. BUILDING TO BE PROTECTED WITH A WET SYSTEM. (CANOPES & ATTIC TO BE PROTECTED WITH A DRY SYSTEM). THIS INCLUDES ALL REQUIRED STANDPIPES, FIRE PUMPS, FIRE DEPARTMENT CONNECTIONS AND WATER MAIN.
3. SPRINKLER HEADS SHALL BE QUICK RESPONSE IN LIGHT HAZARD AREAS.
4. ALL SPRINKLER HEADS IN FINISHED AREAS TO BE CONCEALED WITH WHITE COVER PLATES, 185° 1/2" ORIFICE.
5. HEADS TO BE CENTERED IN AREAS WITH ACOUSTICAL CEILING TILES.
6. EXPOSED AREAS TO HAVE BRASS UPRIGHT HEADS.
7. COORDINATE FIRE DEPARTMENT CONNECTION WITH THE CITY OF HASTINGS.
8. EXISTING CONDITIONS TO BE FIELD VERIFIED.
9. COORDINATE FIRE PROTECTION LINES WITH LIGHTS, DUCTS, CEILING GRIDS, BULKHEADS, ETC.
10. COORDINATE FIRE PROTECTION REQUIREMENTS WITH OWNERS INSURANCE COMPANY.
11. FIRE PUMP AND STORAGE TANK TO BE SIZED PER NFPA. EXISTING WELL TO BE UTILIZED.



E2W ENGINEERING

161 East Michigan Ave

Suite 200

Kalamazoo, MI 49007

PHONE: (269) 373-8000

FAX: (269) 373-5641

This drawing, as an instrument of service, is owned by E2W Engineering, LLC. Reproduction of this document is prohibited without express authorization from the engineer.

©2011 E2W Engineering, LLC

THE COTTAGE at THORNAPPLE

Hastings, MI

PROJ. NO.: 2011-11-021

02/21/12 ISSUED FOR BIDS
03/15/12 ADDENDUM #3

CONSTRUCTION MANAGER

CM CONTRACTING

CIVIL ENGINEER

HURLEY & STEWART

STRUCTURAL ENGINEER

JDH ENGINEERING

MFP ENGINEER

E2W ENGINEERING

2000 SERVICE CONSULTANT

MILLIS & ASSOCIATES

REGISTERED PROFESSIONAL ENGINEER

ECKERT WORDELL

ARCHITECTURE • ENGINEERING • INTERIOR DESIGN

161 East Michigan Ave, Suite 200

Kalamazoo, MI 49007-3807

PHONE: 269 388 7313

FAX: 269 388 7300

WEB: www.eckert-wordell.com

© 2011 Eckert Wordell, LLC

ATTIC FIRE PROTECTION PLAN

FP120

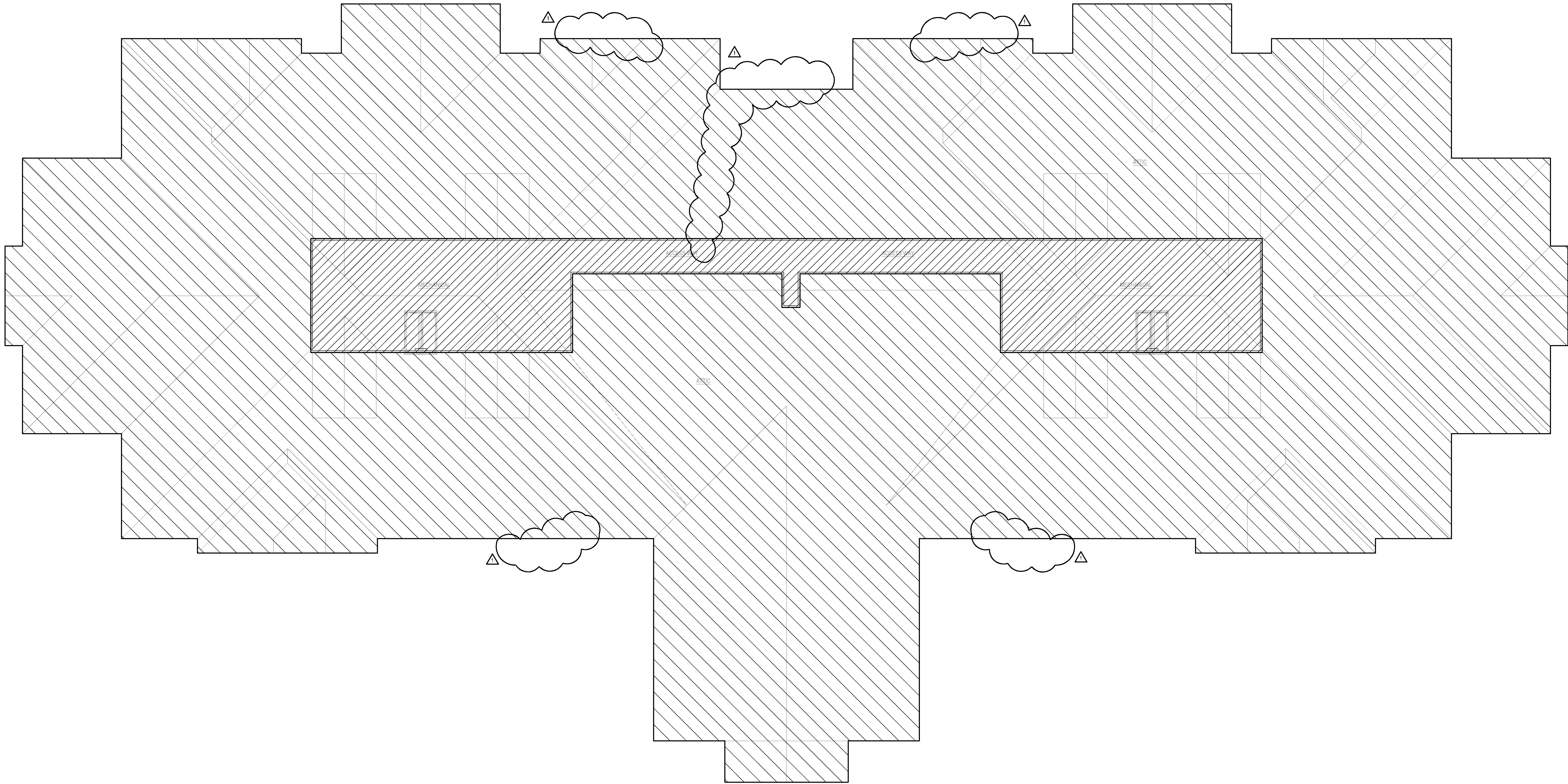

1 ATTIC FIRE PROTECTION PLAN

SCALE: 1/8"=1'-0"

